

Proposed FFL

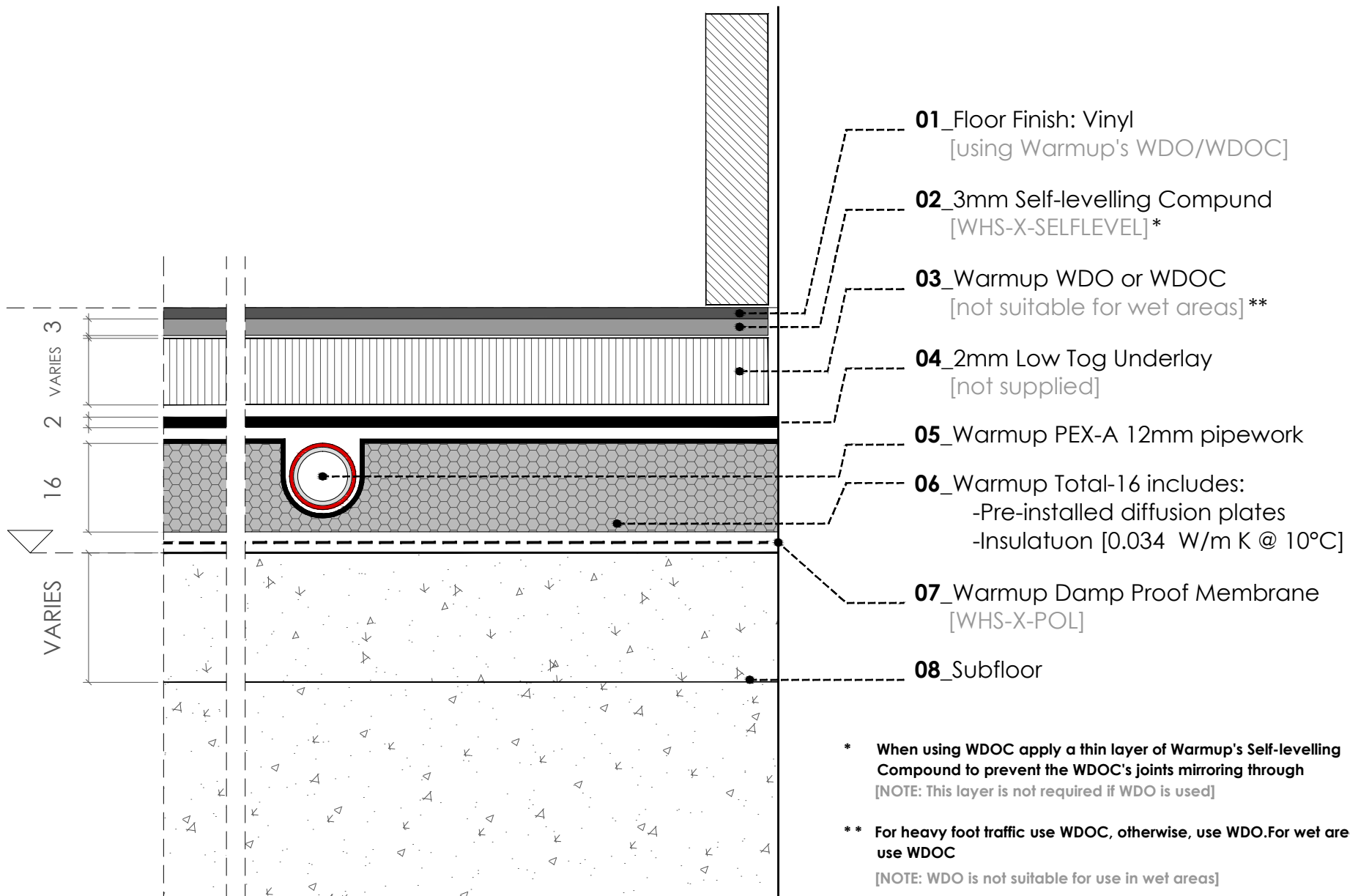

- 01_Floor Finish: Vinyl
[using Warmup's WDO/WDOC]
- 02_3mm Self-levelling Compound
[WHS-X-SELFLEVEL]*
- 03_Warmup WDO or WDOC
[not suitable for wet areas]**
- 04_2mm Low Tog Underlay
[not supplied]
- 05_Warmup PEX-A 12mm pipework
- 06_Warmup Total-16 includes:
-Pre-installed diffusion plates
-Insulation [0.034 W/m K @ 10°C]
- 07_Warmup Damp Proof Membrane
[WHS-X-POL]
- 08_Subfloor

* When using WDOC apply a thin layer of Warmup's Self-levelling Compound to prevent the WDOC's joints mirroring through
[NOTE: This layer is not required if WDO is used]

** For heavy foot traffic use WDOC, otherwise, use WDO. For wet areas use WDOC
[NOTE: WDO is not suitable for use in wet areas]



The world's best-selling floor heating brand™

WARMUP PLC, 702 Tudor Estate, Abbey Road, London, NW10 7UW
Tel 0845 034 8270 Fax 0208 453 6869
projects@warmup.com www.warmup.co.uk

© This drawing is confidential and may not be used, copied or disclosed to anyone without permission of Warmup Plc. The Copyright of these drawings remain the property of Warmup Plc. Do not scale from drawings, all dimensions to be checked on site. The Warmup word and associated logos are trade marks. © Warmup Plc. 2010 - Regd. TM Nos. 1257757, 4409926, 5265707, E & OE. Registered in England No. 2955213.

TITLE:	TOTAL-16_Vinyl [using Warmup's WDO/WDOC]		
SCALE:	1.1_A4	DATE:	10.06.2015
DESIGNER:	ALBERTO A	VERSION:	03