

REV	DATE	DESCRIPTION	DR	CH



Warmup

The world's **best-selling** floor heating brand™

WARMUP PLC, 704 Tudor Estate, Abbey Road, London, NW10 7UW
 Tel 0845 034 8270 Fax 0208 453 6869
cad@warmup.com projects@warmup.com www.warmup.co.uk

DRAWING ISSUE STATUS		DRAWING NO
CONSTRUCTION		01
PROJECT		
TECTORA JOISTED BATTEN FLOOR SYSTEM		
CONCRETE SUBFLOOR		
TITLE		
GENERIC TEMPLATE		
DETAILED SECTION		
PROJECT MANAGER	DRAWN	CHECKED
	AA	AW
DATE	SCALE	REVISION
29.12.2016	1:50@A3	
CAD FILE		
20161228-H-TECTORA-DET SECTIONS.DWG		

WARMUP TECTORA JOISTED BATTEN FLOOR SYSTEM. Concrete subfloor. Generic template

© This drawing is confidential and may not be used, copied or disclosed to anyone without permission of Warmup Plc. The Copyright of these drawings remain the property of Warmup Plc.

Do not scale from drawings, all dimensions to be checked on site.

The Warmup word and associated logos are trade marks. © Warmup Plc. 2010 - Regd. TM Nos. 1257757, 4409926, 5265707. E & OE. Registered in England No. 2955213.

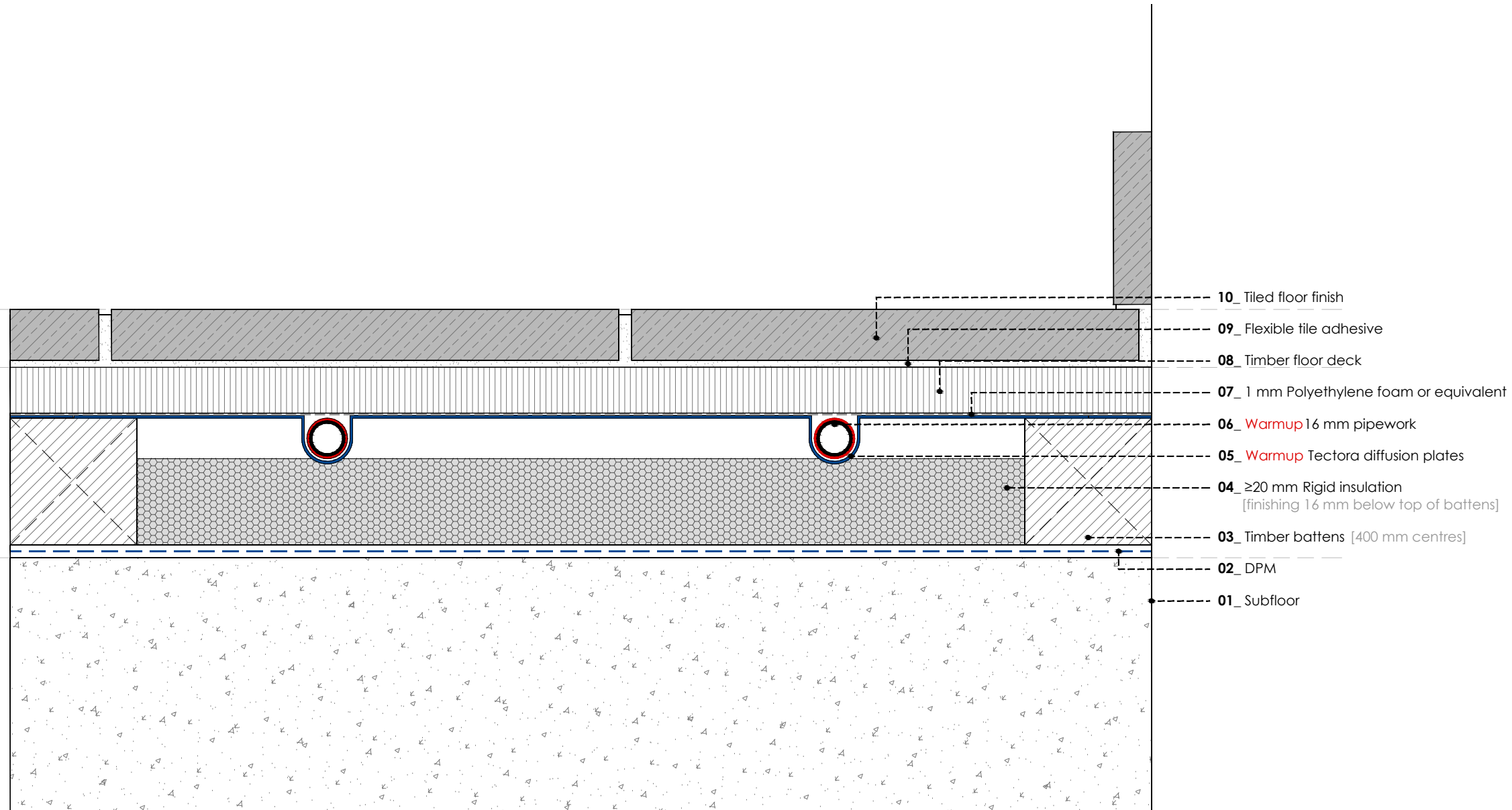

REV	DATE	DESCRIPTION	DR	CH



Warmup

The world's **best-selling** floor heating brand™

WARMUP PLC, 704 Tudor Estate, Abbey Road, London, NW10 7UW
 Tel 0845 034 8270 Fax 0208 453 6869
cad@warmup.com projects@warmup.com www.warmup.co.uk

DRAWING ISSUE STATUS		DRAWING NO
CONSTRUCTION		02
PROJECT		
TECTORA JOISTED BATTEN FLOOR SYSTEM		
CONCRETE SUBFLOOR		
TITLE		
TILED FLOOR		
DETAILED SECTION		
PROJECT MANAGER	DRAWN	CHECKED
	AA	AW
DATE	SCALE	REVISION
29.12.2016	1:50@A3	
CAD FILE		
20161228-H-TECTORA-DET SECTIONS.DWG		

WARMUP TECTORA JOISTED BATTEN FLOOR SYSTEM. Concrete subfloor. Tiled floor

© This drawing is confidential and may not be used, copied or disclosed to anyone without permission of Warmup Plc. The Copyright of these drawings remain the property of Warmup Plc.

Do not scale from drawings, all dimensions to be checked on site.

The Warmup word and associated logos are trade marks. © Warmup Plc. 2010 - Regd. TM Nos. 1257757, 4409926, 5265707. E & OE. Registered in England No. 2955213.

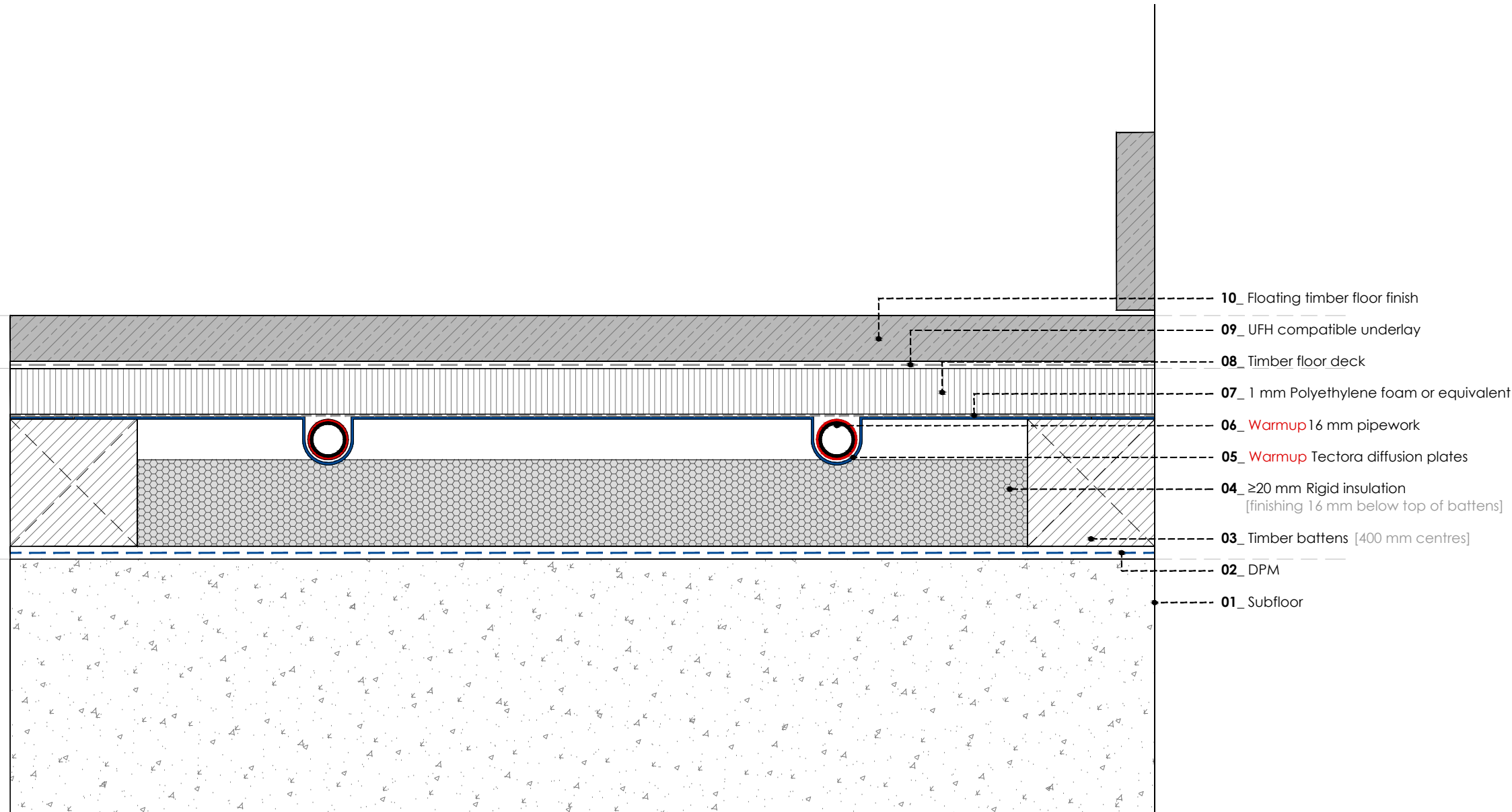

- 10_ Floating timber floor finish
- 09_ UFH compatible underlay
- 08_ Timber floor deck
- 07_ 1 mm Polyethylene foam or equivalent
- 06_ Warmup 16 mm pipework
- 05_ Warmup Tectora diffusion plates
- 04_ ≥20 mm Rigid insulation
[finishing 16 mm below top of battens]
- 03_ Timber battens [400 mm centres]
- 02_ DPM
- 01_ Subfloor

REV	DATE	DESCRIPTION	DR	CH



Warmup

The world's **best-selling** floor heating brand™

WARMUP PLC, 704 Tudor Estate, Abbey Road, London, NW10 7UW
Tel 0845 034 8270 Fax 0208 453 6869
cad@warmup.com projects@warmup.com www.warmup.co.uk

DRAWING ISSUE STATUS		DRAWING NO
CONSTRUCTION		03
PROJECT		
TECTORA JOISTED BATTEN FLOOR SYSTEM		
CONCRETE SUBFLOOR		
TITLE		
WOOD / LAMINATE FLOOR - FLOATING		
DETAILED SECTION		
PROJECT MANAGER	DRAWN	CHECKED
	AA	AW
DATE	SCALE	REVISION
29.12.2016	1:50@A3	
CAD FILE		
20161228-H-TECTORA-DET SECTIONS.DWG		

WARMUP TECTORA JOISTED BATTEN FLOOR SYSTEM. Concrete subfloor. Wood / Laminate floor - floating

© This drawing is confidential and may not be used, copied or disclosed to anyone without permission of Warmup Plc. The Copyright of these drawings remain the property of Warmup Plc.

Do not scale from drawings, all dimensions to be checked on site.

The Warmup word and associated logos are trade marks. © Warmup Plc. 2010 - Regd. TM Nos. 1257757, 4409926, 5265707. E & OE. Registered in England No. 2955213.

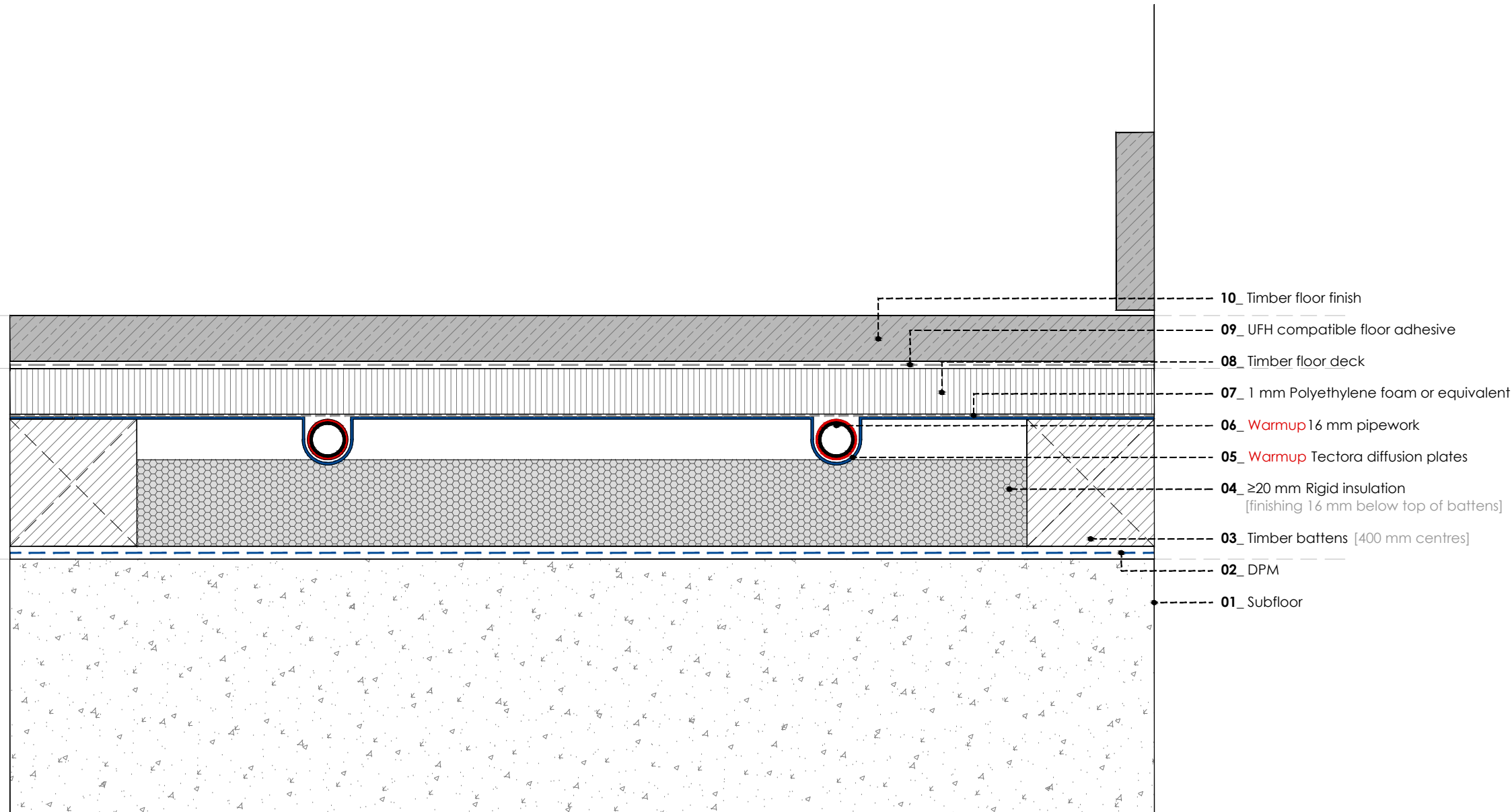

- 10_ Timber floor finish
- 09_ UFH compatible floor adhesive
- 08_ Timber floor deck
- 07_ 1 mm Polyethylene foam or equivalent
- 06_ Warmup 16 mm pipework
- 05_ Warmup Tectora diffusion plates
- 04_ ≥20 mm Rigid insulation
[finishing 16 mm below top of battens]
- 03_ Timber battens [400 mm centres]
- 02_ DPM
- 01_ Subfloor

REV	DATE	DESCRIPTION	DR	CH



Warmup

The world's best-selling floor heating brand™

WARMUP PLC, 704 Tudor Estate, Abbey Road, London, NW10 7UW
Tel 0845 034 8270 Fax 0208 453 6869
cad@warmup.com projects@warmup.com www.warmup.co.uk

DRAWING ISSUE STATUS		DRAWING NO
CONSTRUCTION		04
PROJECT		
TECTORA JOISTED BATTEN FLOOR SYSTEM		
CONCRETE SUBFLOOR		
TITLE		
WOOD / LAMINATE FLOOR - GLUED		
DETAILED SECTION		
PROJECT MANAGER	DRAWN	CHECKED
	AA	AW
DATE	SCALE	REVISION
29.12.2016	1:50@A3	
CAD FILE		
20161228-H-TECTORA-DET SECTIONS.DWG		

WARMUP TECTORA JOISTED BATTEN FLOOR SYSTEM. Concrete subfloor. Wood / Laminate floor - glued

© This drawing is confidential and may not be used, copied or disclosed to anyone without permission of Warmup Plc. The Copyright of these drawings remain the property of Warmup Plc.

Do not scale from drawings, all dimensions to be checked on site.

The Warmup word and associated logos are trade marks. © Warmup Plc. 2010 - Regd. TM Nos. 1257757, 4409926, 5265707. E & OE. Registered in England No. 2955213.

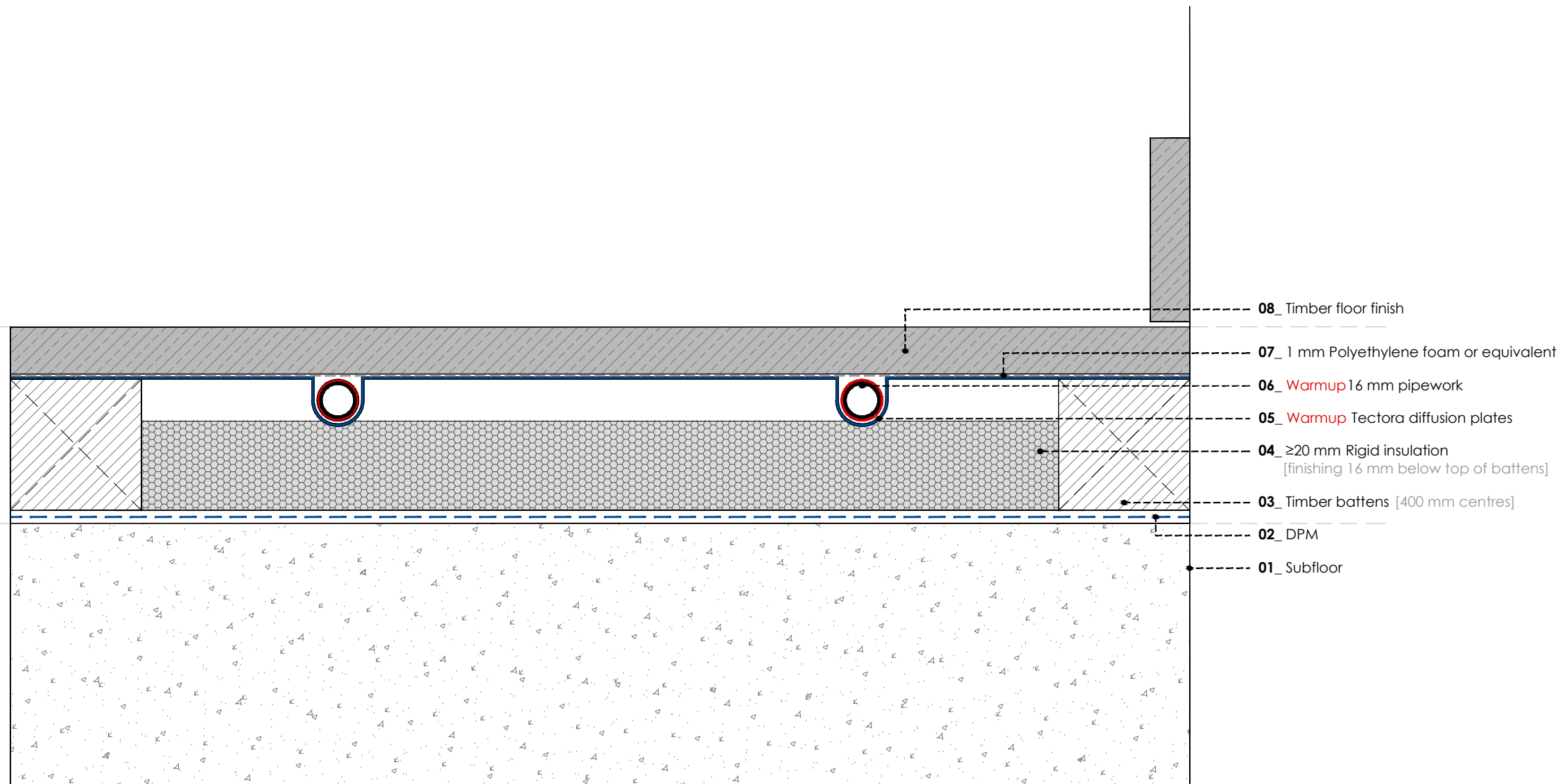

- 08_ Timber floor finish
- 07_ 1 mm Polyethylene foam or equivalent
- 06_ Warmup 16 mm pipework
- 05_ Warmup Tectora diffusion plates
- 04_ ≥20 mm Rigid insulation
[finishing 16 mm below top of battens]
- 03_ Timber battens [400 mm centres]
- 02_ DPM
- 01_ Subfloor

REV	DATE	DESCRIPTION	DR	CH



Warmup

The world's best-selling floor heating brand™

WARMUP PLC, 704 Tudor Estate, Abbey Road, London, NW10 7UW
Tel 0845 034 8270 Fax 0208 453 6869
cad@warmup.com projects@warmup.com www.warmup.co.uk

DRAWING ISSUE STATUS		DRAWING NO
CONSTRUCTION		05
PROJECT		
TECTORA JOISTED BATTEN FLOOR SYSTEM		
CONCRETE SUBFLOOR		
TITLE		
WOOD/LAMINATE FLOOR-SCREWED/NAILED		
DETAILED SECTION		
PROJECT MANAGER	DRAWN	CHECKED
	AA	AW
DATE	SCALE	REVISION
29.12.2016	1:50@A3	
CAD FILE		
20161228-H-TECTORA-DET SECTIONS.DWG		

WARMUP TECTORA JOISTED BATTEN FLOOR SYSTEM. Concrete subfloor. Wood / Laminate floor -screwed / nailed

© This drawing is confidential and may not be used, copied or disclosed to anyone without permission of Warmup Plc. The Copyright of these drawings remain the property of Warmup Plc.

Do not scale from drawings, all dimensions to be checked on site.

The Warmup word and associated logos are trade marks. © Warmup Plc. 2010 - Regd. TM Nos. 1257757, 4409926, 5265707. E & OE. Registered in England No. 2955213.

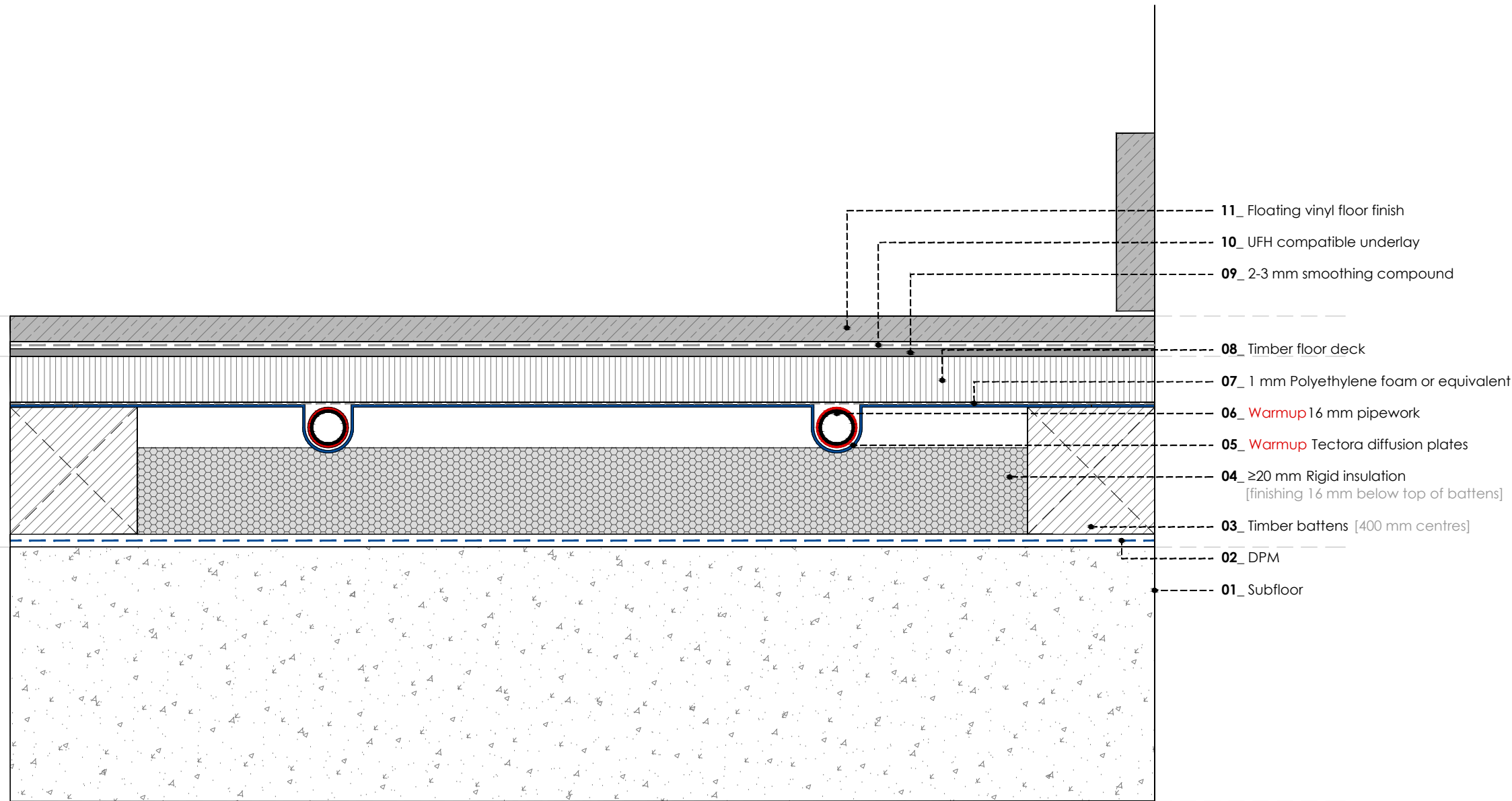

REV	DATE	DESCRIPTION	DR	CH



The world's best-selling floor heating brand™

WARMUP PLC, 704 Tudor Estate, Abbey Road, London, NW10 7UW
 Tel 0845 034 8270 Fax 0208 453 6869
cad@warmup.com projects@warmup.com www.warmup.co.uk

DRAWING ISSUE STATUS		DRAWING NO
CONSTRUCTION		06
PROJECT		
TECTORA JOISTED BATTEN FLOOR SYSTEM		
CONCRETE SUBFLOOR		
TITLE		
VINYL FLOOR - FLOATING		
DETAILED SECTION		
PROJECT MANAGER	DRAWN	CHECKED
	AA	AW
DATE	SCALE	REVISION
29.12.2016	1:50@A3	

CAD FILE
 20161228-H-TECTORA-DET SECTIONS.DWG

© This drawing is confidential and may not be used, copied or disclosed to anyone without permission of Warmup Plc. The Copyright of these drawings remain the property of Warmup Plc.

Do not scale from drawings, all dimensions to be checked on site.

The Warmup word and associated logos are trade marks. © Warmup Plc. 2010 - Regd. TM Nos. 1257757, 4409926, 5265707. E & OE. Registered in England No. 2955213.

WARMUP TECTORA JOISTED BATTEN FLOOR SYSTEM. Concrete subfloor. Vinyl floor - floating

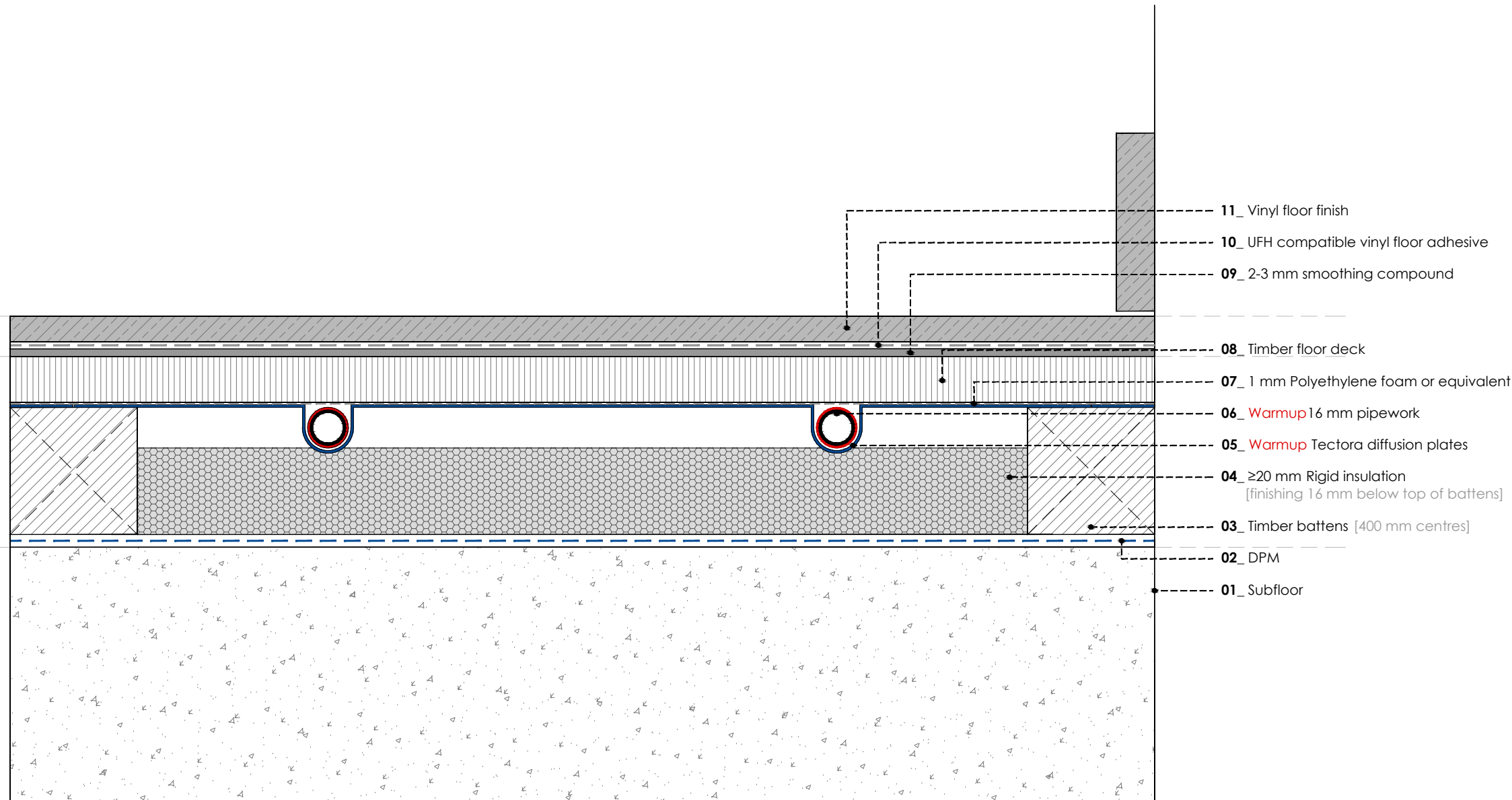

REV	DATE	DESCRIPTION	DR	CH



Warmup

The world's best-selling floor heating brand™

WARMUP PLC, 704 Tudor Estate, Abbey Road, London, NW10 7UW
 Tel 0845 034 8270 Fax 0208 453 6869
cad@warmup.com projects@warmup.com www.warmup.co.uk

DRAWING ISSUE STATUS		DRAWING NO
CONSTRUCTION		07
PROJECT		
TECTORA JOISTED BATTEN FLOOR SYSTEM		
CONCRETE SUBFLOOR		
TITLE		
VINYL FLOOR - GLUED		
DETAILED SECTION		
PROJECT MANAGER	DRAWN	CHECKED
	AA	AW
DATE	SCALE	REVISION
29.12.2016	1:50@A3	
CAD FILE		
20161228-H-TECTORA-DET SECTIONS.DWG		

WARMUP TECTORA JOISTED BATTEN FLOOR SYSTEM. Concrete subfloor. Vinyl floor - glued

© This drawing is confidential and may not be used, copied or disclosed to anyone without permission of Warmup Plc. The Copyright of these drawings remain the property of Warmup Plc.

Do not scale from drawings, all dimensions to be checked on site.

The Warmup word and associated logos are trade marks. © Warmup Plc. 2010 - Regd. TM Nos. 1257757, 4409926, 5265707. E & OE. Registered in England No. 2955213.

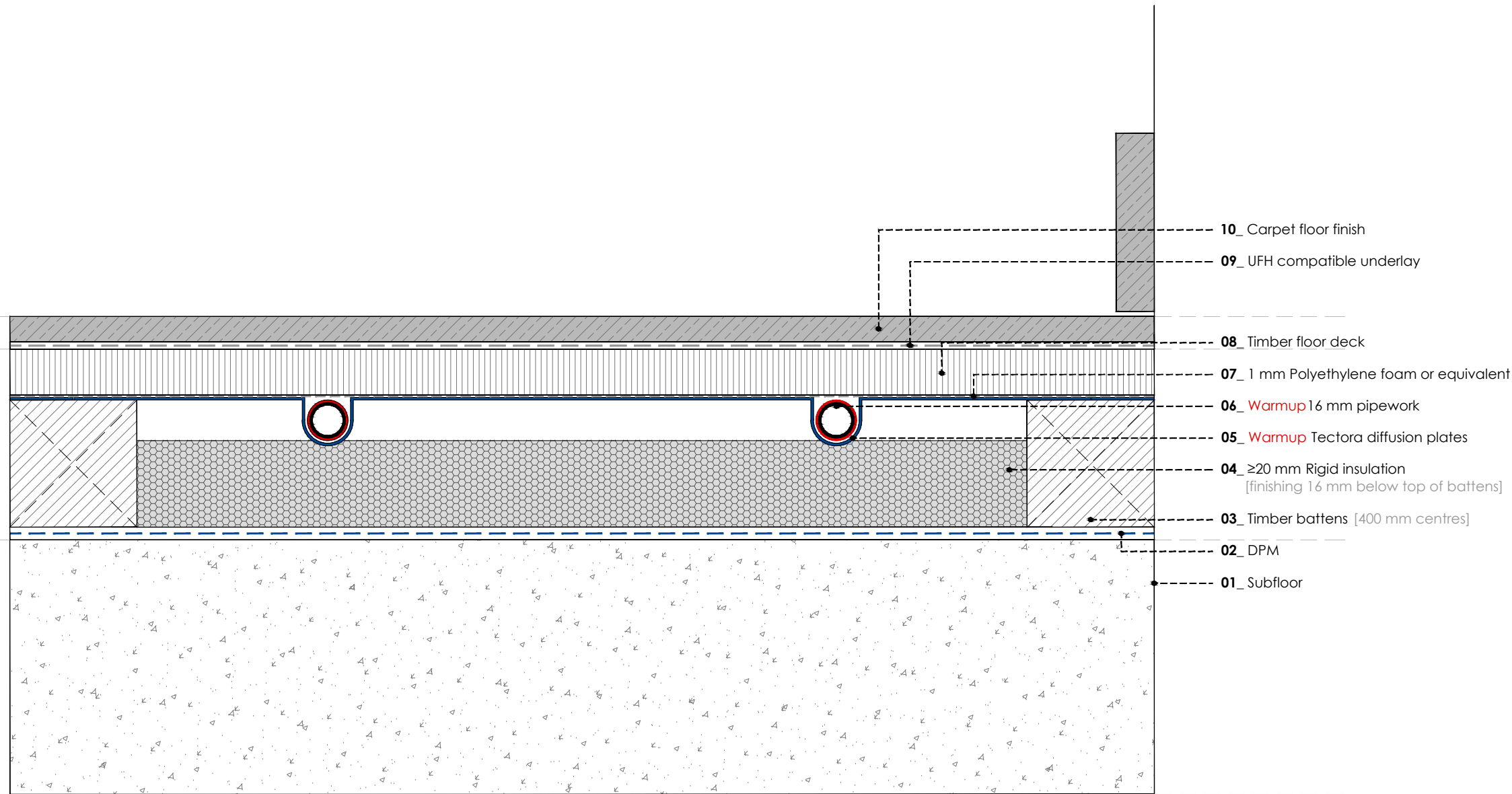

- 10_ Carpet floor finish
- 09_ UFH compatible underlay
- 08_ Timber floor deck
- 07_ 1 mm Polyethylene foam or equivalent
- 06_ Warmup 16 mm pipework
- 05_ Warmup Tectora diffusion plates
- 04_ ≥20 mm Rigid insulation
[finishing 16 mm below top of battens]
- 03_ Timber battens [400 mm centres]
- 02_ DPM
- 01_ Subfloor

REV	DATE	DESCRIPTION	DR	CH



Warmup

The world's best-selling floor heating brand™

WARMUP PLC, 704 Tudor Estate, Abbey Road, London, NW10 7UW
Tel 0845 034 8270 Fax 0208 453 6869
cad@warmup.com projects@warmup.com www.warmup.co.uk

DRAWING ISSUE STATUS		DRAWING NO
CONSTRUCTION		08
PROJECT		
TECTORA JOISTED BATTEN FLOOR SYSTEM CONCRETE SUBFLOOR		
TITLE		
CARPET FLOOR DETAILED SECTION		
PROJECT MANAGER	DRAWN	CHECKED
	AA	AW
DATE	SCALE	REVISION
29.12.2016	1:50@A3	
CAD FILE		
20161228-H-TECTORA-DET SECTIONS.DWG		

WARMUP TECTORA JOISTED BATTEN FLOOR SYSTEM. Concrete subfloor. Carpet floor

© This drawing is confidential and may not be used, copied or disclosed to anyone without permission of Warmup Plc. The Copyright of these drawings remain the property of Warmup Plc.

Do not scale from drawings, all dimensions to be checked on site.

The Warmup word and associated logos are trade marks. © Warmup Plc. 2010 - Regd. TM Nos. 1257757, 4409926, 5265707. E & OE. Registered in England No. 2955213.