

REV	DATE	DESCRIPTION	DR	CH



# Warmup

The world's **best-selling** floor heating brand™

WARMUP PLC, 704 Tudor Estate, Abbey Road, London, NW10 7UW  
 Tel 0845 034 8270 Fax 0208 453 6869  
[cad@warmup.com](mailto:cad@warmup.com) [projects@warmup.com](mailto:projects@warmup.com) [www.warmup.co.uk](http://www.warmup.co.uk)

<b>DRAWING ISSUE STATUS</b>		<b>DRAWING NO</b>
<b>CONSTRUCTION</b>		01
<b>PROJECT</b>		
<b>TECTORA JOISTED BATTEN FLOOR SYSTEM</b>		
CONCRETE SUBFLOOR		
<b>TITLE</b>		
GENERIC TEMPLATE		
<b>DETAILED SECTION</b>		
<b>PROJECT MANAGER</b>	<b>DRAWN</b>	<b>CHECKED</b>
	AA	AW
<b>DATE</b>	<b>SCALE</b>	<b>REVISION</b>
01.03.2017	1:50@A3	
<b>CAD FILE</b>		
20170228-H-TECTORA-DET SECTIONS.DWG		

## WARMUP TECTORA JOISTED BATTEN FLOOR SYSTEM. Concrete subfloor. Generic template

\* Pipes need to be clipped to the insulation on turns

\*\* Channel a groove in the floor deck to allow for floor sensor installation

© This drawing is confidential and may not be used, copied or disclosed to anyone without permission of Warmup Plc. The Copyright of these drawings remain the property of Warmup Plc.

Do not scale from drawings, all dimensions to be checked on site.

The Warmup word and associated logos are trade marks. © Warmup Plc. 2010 - Regd. TM Nos. 1257757, 4409926, 5265707. E & OE. Registered in England No. 2955213.

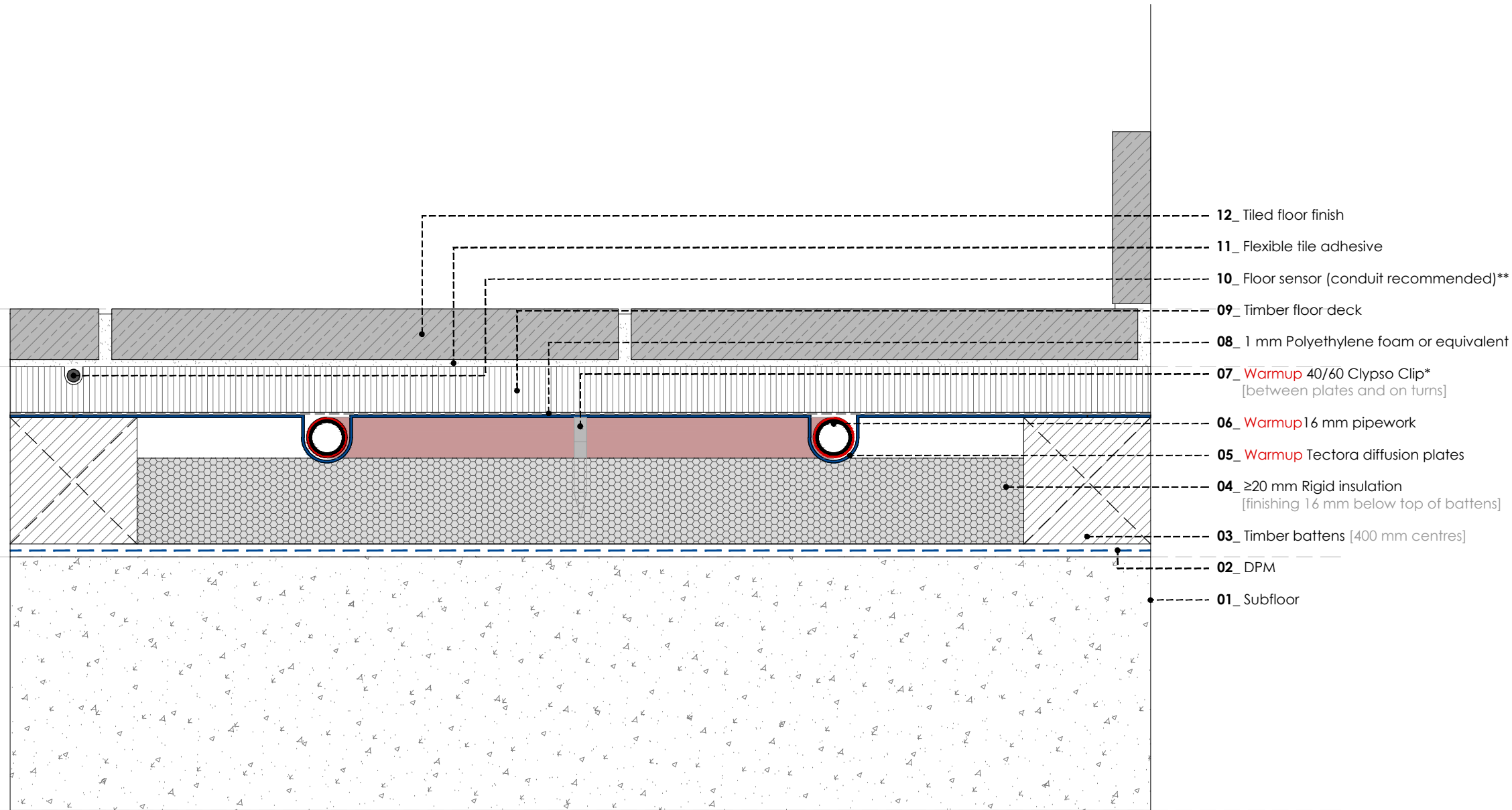

REV	DATE	DESCRIPTION	DR	CH



# Warmup

The world's **best-selling** floor heating brand™

WARMUP PLC, 704 Tudor Estate, Abbey Road, London, NW10 7UW  
 Tel 0845 034 8270 Fax 0208 453 6869  
[cad@warmup.com](mailto:cad@warmup.com) [projects@warmup.com](mailto:projects@warmup.com) [www.warmup.co.uk](http://www.warmup.co.uk)

<b>DRAWING ISSUE STATUS</b>		<b>DRAWING NO</b>
<b>CONSTRUCTION</b>		02
<b>PROJECT</b>		
<b>TECTORA JOISTED BATTEN FLOOR SYSTEM</b>		
<b>CONCRETE SUBFLOOR</b>		
<b>TITLE</b>		
<b>TILED FLOOR</b>		
<b>DETAILED SECTION</b>		
<b>PROJECT MANAGER</b>	<b>DRAWN</b>	<b>CHECKED</b>
	AA	AW
<b>DATE</b>	<b>SCALE</b>	<b>REVISION</b>
01.03.2017	1:50@A3	
<b>CAD FILE</b>		
20170228-H-TECTORA-DET SECTIONS.DWG		

## WARMUP TECTORA JOISTED BATTEN FLOOR SYSTEM. Concrete subfloor. Tiled floor

- \* Pipes need to be clipped to the insulation on turns
- \*\* Channel a groove in the floor deck to allow for floor sensor installation

© This drawing is confidential and may not be used, copied or disclosed to anyone without permission of Warmup Plc. The Copyright of these drawings remain the property of Warmup Plc.

Do not scale from drawings, all dimensions to be checked on site.

The Warmup word and associated logos are trade marks. © Warmup Plc. 2010 - Regd. TM Nos. 1257757, 4409926, 5265707. E & OE. Registered in England No. 2955213.

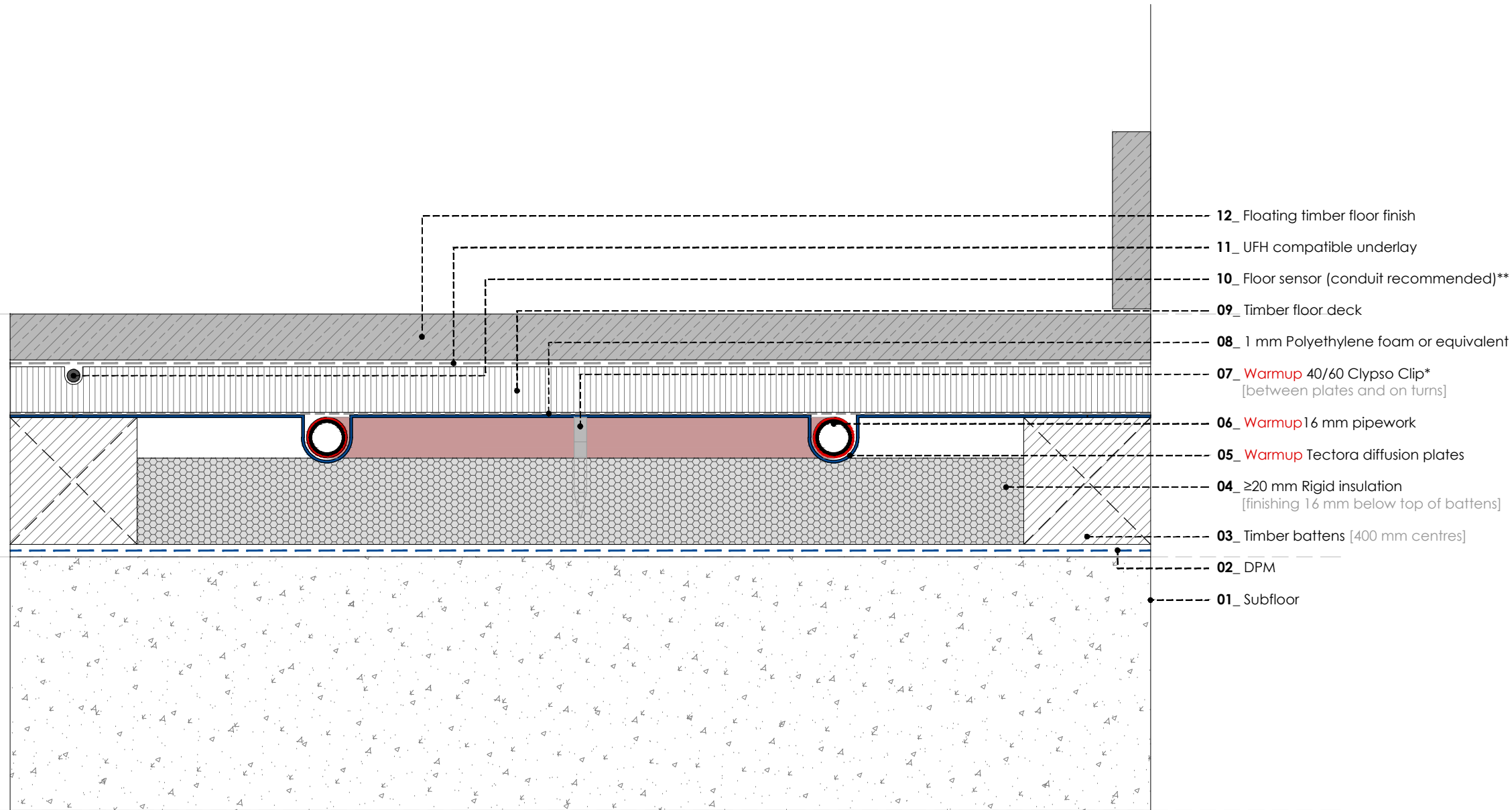

REV	DATE	DESCRIPTION	DR	CH



# Warmup

The world's **best-selling** floor heating brand™

WARMUP PLC, 704 Tudor Estate, Abbey Road, London, NW10 7UW  
 Tel 0845 034 8270 Fax 0208 453 6869  
[cad@warmup.com](mailto:cad@warmup.com) [projects@warmup.com](mailto:projects@warmup.com) [www.warmup.co.uk](http://www.warmup.co.uk)

<b>DRAWING ISSUE STATUS</b>		<b>DRAWING NO</b>
<b>CONSTRUCTION</b>		03
<b>PROJECT</b>		
<b>TECTORA JOISTED BATTEN FLOOR SYSTEM</b>		
CONCRETE SUBFLOOR		
<b>TITLE</b>		
WOOD / LAMINATE FLOOR - FLOATING		
<b>DETAILED SECTION</b>		
<b>PROJECT MANAGER</b>	<b>DRAWN</b>	<b>CHECKED</b>
	AA	AW
<b>DATE</b>	<b>SCALE</b>	<b>REVISION</b>
01.03.2017	1:50@A3	
<b>CAD FILE</b>		
20170228-H-TECTORA-DET SECTIONS.DWG		

## WARMUP TECTORA JOISTED BATTEN FLOOR SYSTEM. Concrete subfloor. Wood / Laminate floor - floating

\* Pipes need to be clipped to the insulation on turns

\*\* Channel a groove in the floor deck to allow for floor sensor installation

© This drawing is confidential and may not be used, copied or disclosed to anyone without permission of Warmup Plc. The Copyright of these drawings remain the property of Warmup Plc.

Do not scale from drawings, all dimensions to be checked on site.

The Warmup word and associated logos are trade marks. © Warmup Plc. 2010 - Regd. TM Nos. 1257757, 4409926, 5265707. E & OE. Registered in England No. 2955213.

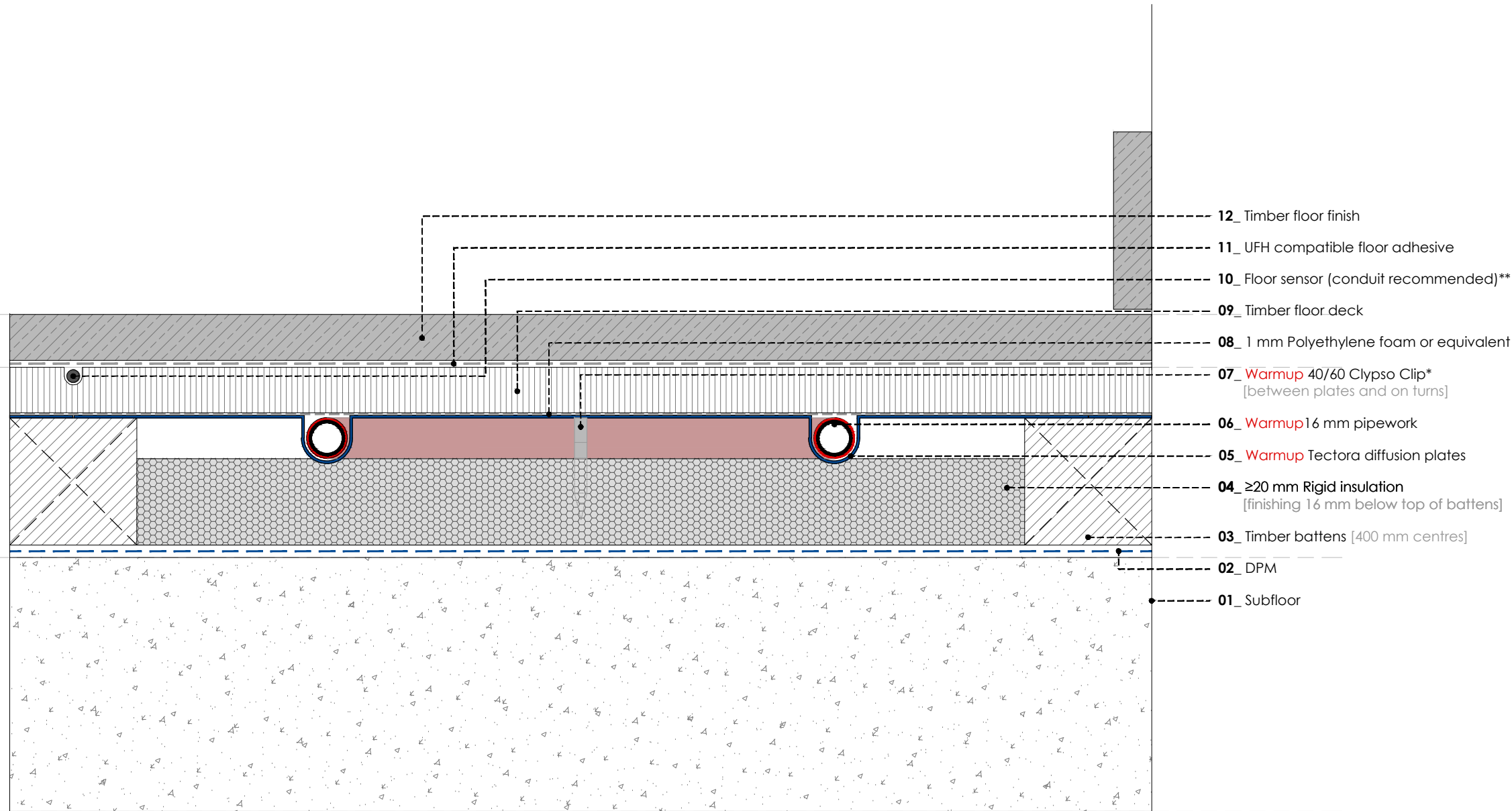

REV	DATE	DESCRIPTION	DR	CH



# Warmup

The world's **best-selling** floor heating brand™

WARMUP PLC, 704 Tudor Estate, Abbey Road, London, NW10 7UW  
 Tel 0845 034 8270 Fax 0208 453 6869  
[cad@warmup.com](mailto:cad@warmup.com) [projects@warmup.com](mailto:projects@warmup.com) [www.warmup.co.uk](http://www.warmup.co.uk)

<b>DRAWING ISSUE STATUS</b>		<b>DRAWING NO</b>
<b>CONSTRUCTION</b>		04
<b>PROJECT</b>		
<b>TECTORA JOISTED BATTEN FLOOR SYSTEM</b>		
CONCRETE SUBFLOOR		
<b>TITLE</b>		
WOOD / LAMINATE FLOOR - GLUED		
<b>DETAILED SECTION</b>		
<b>PROJECT MANAGER</b>	<b>DRAWN</b>	<b>CHECKED</b>
	AA	AW
<b>DATE</b>	<b>SCALE</b>	<b>REVISION</b>
01.03.2017	1:50@A3	
<b>CAD FILE</b>		
20170228-H-TECTORA-DET SECTIONS.DWG		

## WARMUP TECTORA JOISTED BATTEN FLOOR SYSTEM. Concrete subfloor. Wood / Laminate floor - glued

\* Pipes need to be clipped to the insulation on turns

\*\* Channel a groove in the floor deck to allow for floor sensor installation

© This drawing is confidential and may not be used, copied or disclosed to anyone without permission of Warmup Plc. The Copyright of these drawings remain the property of Warmup Plc.

Do not scale from drawings, all dimensions to be checked on site.

The Warmup word and associated logos are trade marks. © Warmup Plc. 2010 - Regd. TM Nos. 1257757, 4409926, 5265707. E & OE. Registered in England No. 2955213.

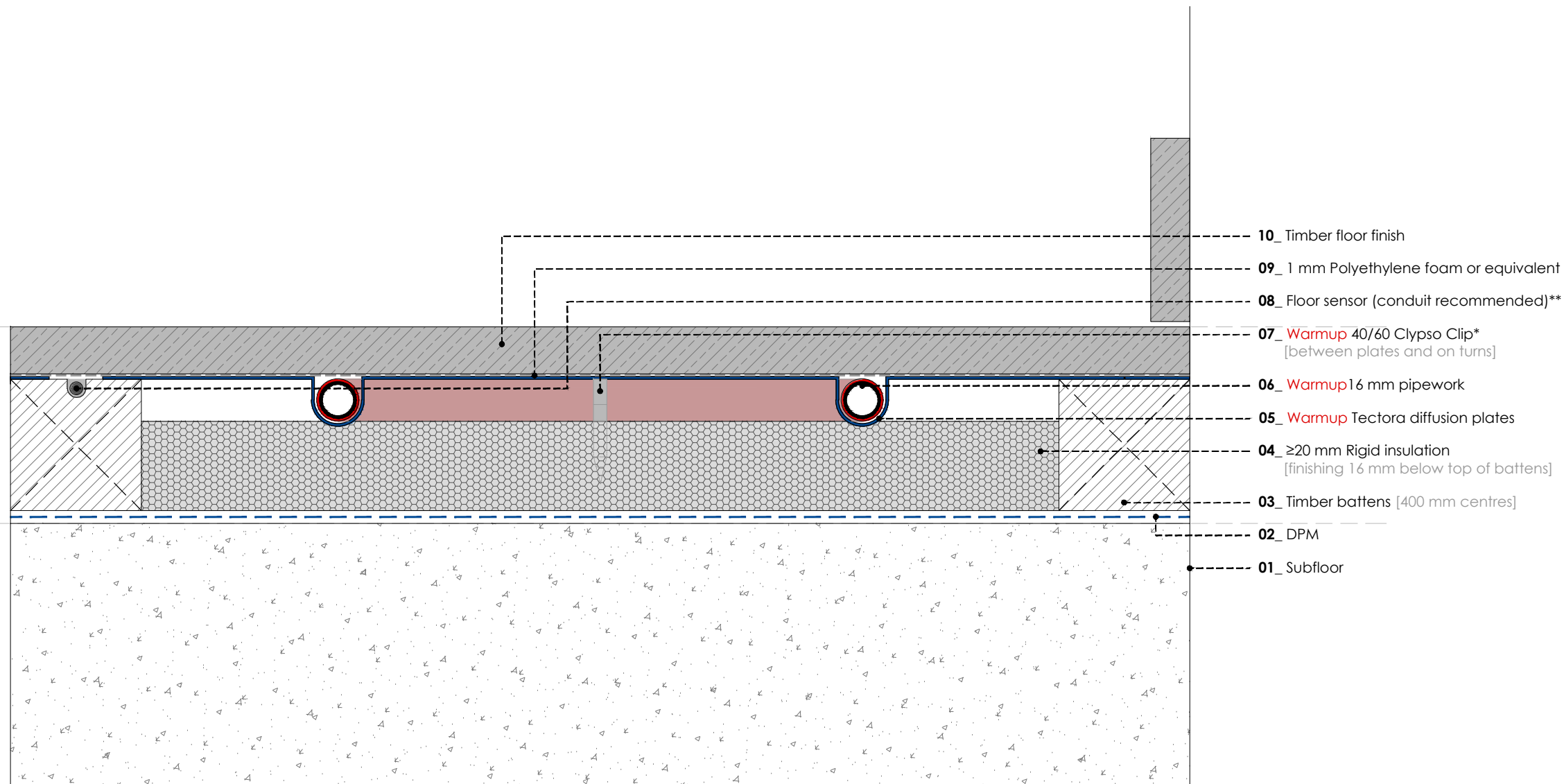

- 10\_ Timber floor finish
- 09\_ 1 mm Polyethylene foam or equivalent
- 08\_ Floor sensor (conduit recommended)\*\*
- 07\_ Warmup 40/60 Clypso Clip\*  
[between plates and on turns]
- 06\_ Warmup 16 mm pipework
- 05\_ Warmup Tectora diffusion plates
- 04\_ ≥20 mm Rigid insulation  
[finishing 16 mm below top of battens]
- 03\_ Timber battens [400 mm centres]
- 02\_ DPM
- 01\_ Subfloor

REV	DATE	DESCRIPTION	DR	CH



# Warmup

The world's **best-selling** floor heating brand™

WARMUP PLC, 704 Tudor Estate, Abbey Road, London, NW10 7UW  
Tel 0845 034 8270 Fax 0208 453 6869  
cad@warmup.com projects@warmup.com www.warmup.co.uk

<b>DRAWING ISSUE STATUS</b>		<b>DRAWING NO</b>
<b>CONSTRUCTION</b>		05
<b>PROJECT</b>		
<b>TECTORA JOISTED BATTEN FLOOR SYSTEM</b>		
CONCRETE SUBFLOOR		
<b>TITLE</b>		
WOOD/LAMINATE FLOOR-SCREWED/NAILED		
<b>DETAILED SECTION</b>		
<b>PROJECT MANAGER</b>	<b>DRAWN</b>	<b>CHECKED</b>
	AA	AW
<b>DATE</b>	<b>SCALE</b>	<b>REVISION</b>
01.03.2017	1:50@A3	
<b>CAD FILE</b>		
20170228-H-TECTORA-DET SECTIONS.DWG		

## WARMUP TECTORA JOISTED BATTEN FLOOR SYSTEM. Concrete subfloor. Wood / Laminate floor -screwed / nailed

\* Pipes need to be clipped to the insulation on turns

\*\* Floor sensor should be placed in a notch, filled with caulk/adhesive, in the batten with the diffuser plate trimmed back 10-15mm.

© This drawing is confidential and may not be used, copied or disclosed to anyone without permission of Warmup Plc. The Copyright of these drawings remain the property of Warmup Plc.

Do not scale from drawings, all dimensions to be checked on site.

The Warmup word and associated logos are trade marks. © Warmup Plc. 2010 - Regd. TM Nos. 1257757, 4409926, 5265707. E & OE. Registered in England No. 2955213.

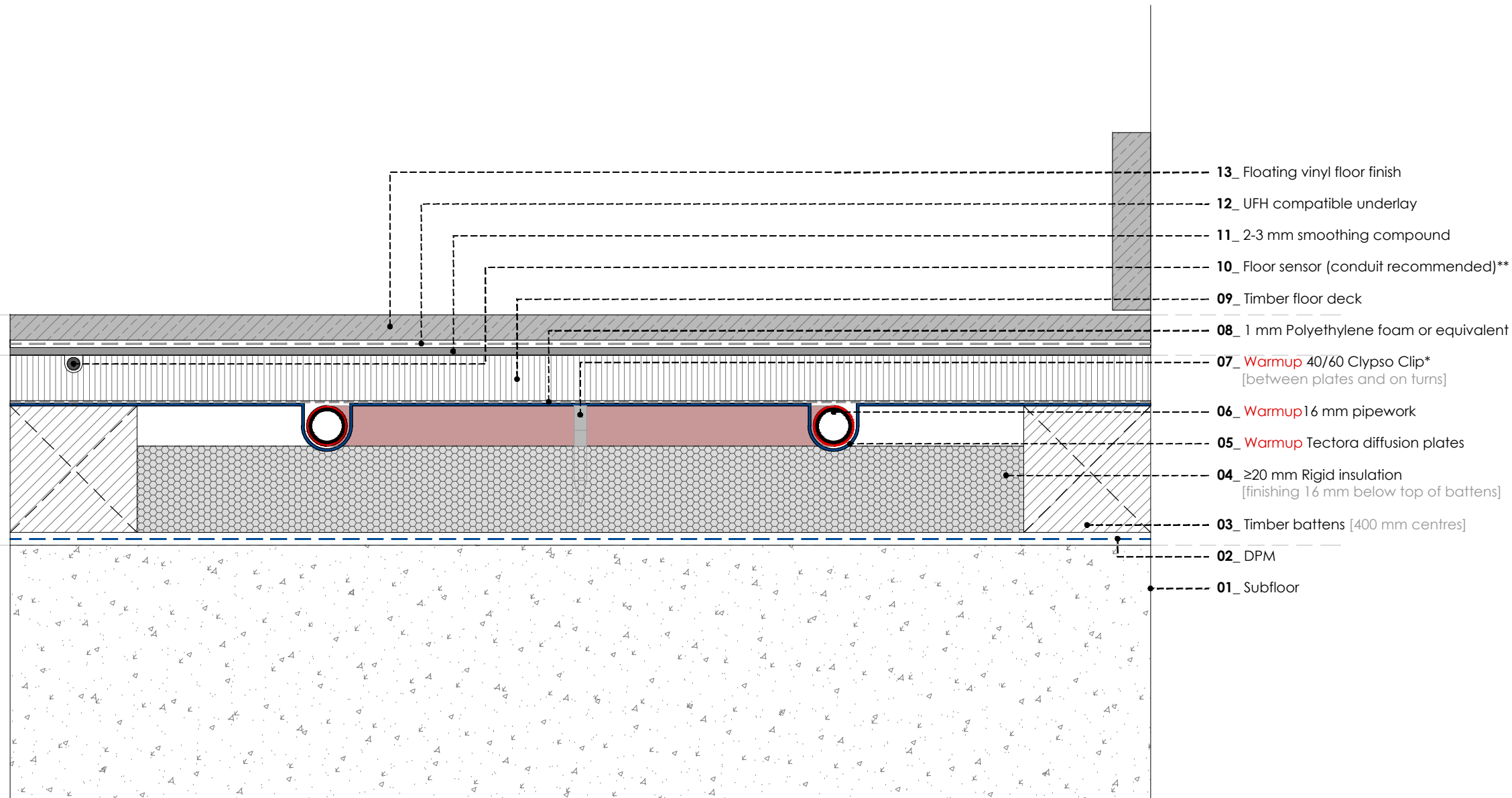

REV	DATE	DESCRIPTION	DR	CH



# Warmup

The world's **best-selling** floor heating brand™

WARMUP PLC, 704 Tudor Estate, Abbey Road, London, NW10 7UW  
 Tel 0845 034 8270 Fax 0208 453 6869  
[cad@warmup.com](mailto:cad@warmup.com) [projects@warmup.com](mailto:projects@warmup.com) [www.warmup.co.uk](http://www.warmup.co.uk)

<b>DRAWING ISSUE STATUS</b>	<b>DRAWING NO</b>
<b>CONSTRUCTION</b>	06

**PROJECT**  
**TECTORA JOISTED BATTEN FLOOR SYSTEM**  
**CONCRETE SUBFLOOR**

**TITLE**  
 VINYL FLOOR - FLOATING  
**DETAILED SECTION**

<b>PROJECT MANAGER</b>	<b>DRAWN</b>	<b>CHECKED</b>
	AA	AW

<b>DATE</b>	<b>SCALE</b>	<b>REVISION</b>
01.03.2017	1:50@A3	

**CAD FILE**  
 20170228-H-TECTORA-DET SECTIONS.DWG

© This drawing is confidential and may not be used, copied or disclosed to anyone without permission of Warmup Plc. The Copyright of these drawings remain the property of Warmup Plc.

Do not scale from drawings, all dimensions to be checked on site.

The Warmup word and associated logos are trade marks. © Warmup Plc. 2010 - Regd. TM Nos. 1257757, 4409926, 5265707. E & OE. Registered in England No. 2955213.

**WARMUP TECTORA JOISTED BATTEN FLOOR SYSTEM. Concrete subfloor. Vinyl floor - floating**

- \* Pipes need to be clipped to the insulation on turns
- \*\* Channel a groove in the floor deck to allow for floor sensor installation

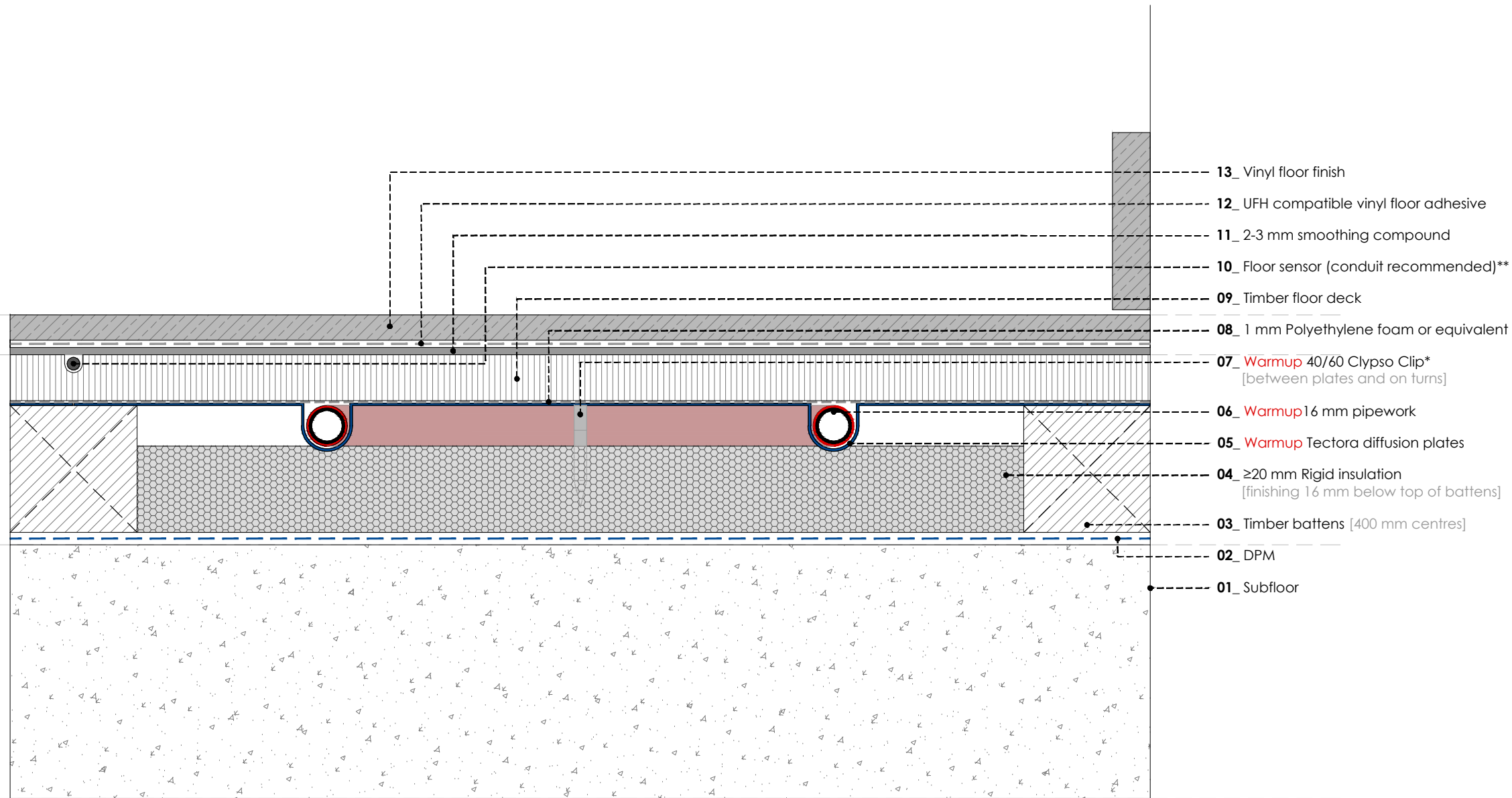

- 13\_ Vinyl floor finish
- 12\_ UFH compatible vinyl floor adhesive
- 11\_ 2-3 mm smoothing compound
- 10\_ Floor sensor (conduit recommended)\*\*
- 09\_ Timber floor deck
- 08\_ 1 mm Polyethylene foam or equivalent
- 07\_ Warmup 40/60 Cypso Clip\*  
[between plates and on turns]
- 06\_ Warmup 16 mm pipework
- 05\_ Warmup Tectora diffusion plates
- 04\_ ≥20 mm Rigid insulation  
[finishing 16 mm below top of battens]
- 03\_ Timber battens [400 mm centres]
- 02\_ DPM
- 01\_ Subfloor

REV	DATE	DESCRIPTION	DR	CH



# Warmup

The world's **best-selling** floor heating brand™

WARMUP PLC, 704 Tudor Estate, Abbey Road, London, NW10 7UW  
Tel 0845 034 8270 Fax 0208 453 6869  
cad@warmup.com projects@warmup.com www.warmup.co.uk

<b>DRAWING ISSUE STATUS</b>		<b>DRAWING NO</b>
<b>CONSTRUCTION</b>		07
<b>PROJECT</b>		
<b>TECTORA JOISTED BATTEN FLOOR SYSTEM CONCRETE SUBFLOOR</b>		
<b>TITLE</b>		
VINYL FLOOR - GLUED		
<b>DETAILED SECTION</b>		
<b>PROJECT MANAGER</b>	<b>DRAWN</b>	<b>CHECKED</b>
	AA	AW
<b>DATE</b>	<b>SCALE</b>	<b>REVISION</b>
01.03.2017	1:50@A3	
<b>CAD FILE</b>		
20170228-H-TECTORA-DET SECTIONS.DWG		

**WARMUP TECTORA JOISTED BATTEN FLOOR SYSTEM. Concrete subfloor. Vinyl floor - glued**

- \* Pipes need to be clipped to the insulation on turns
- \*\* Channel a groove in the floor deck to allow for floor sensor installation

© This drawing is confidential and may not be used, copied or disclosed to anyone without permission of Warmup Plc. The Copyright of these drawings remain the property of Warmup Plc.

Do not scale from drawings, all dimensions to be checked on site.

The Warmup word and associated logos are trade marks. © Warmup Plc. 2010 - Regd. TM Nos. 1257757, 4409926, 5265707. E & OE. Registered in England No. 2955213.

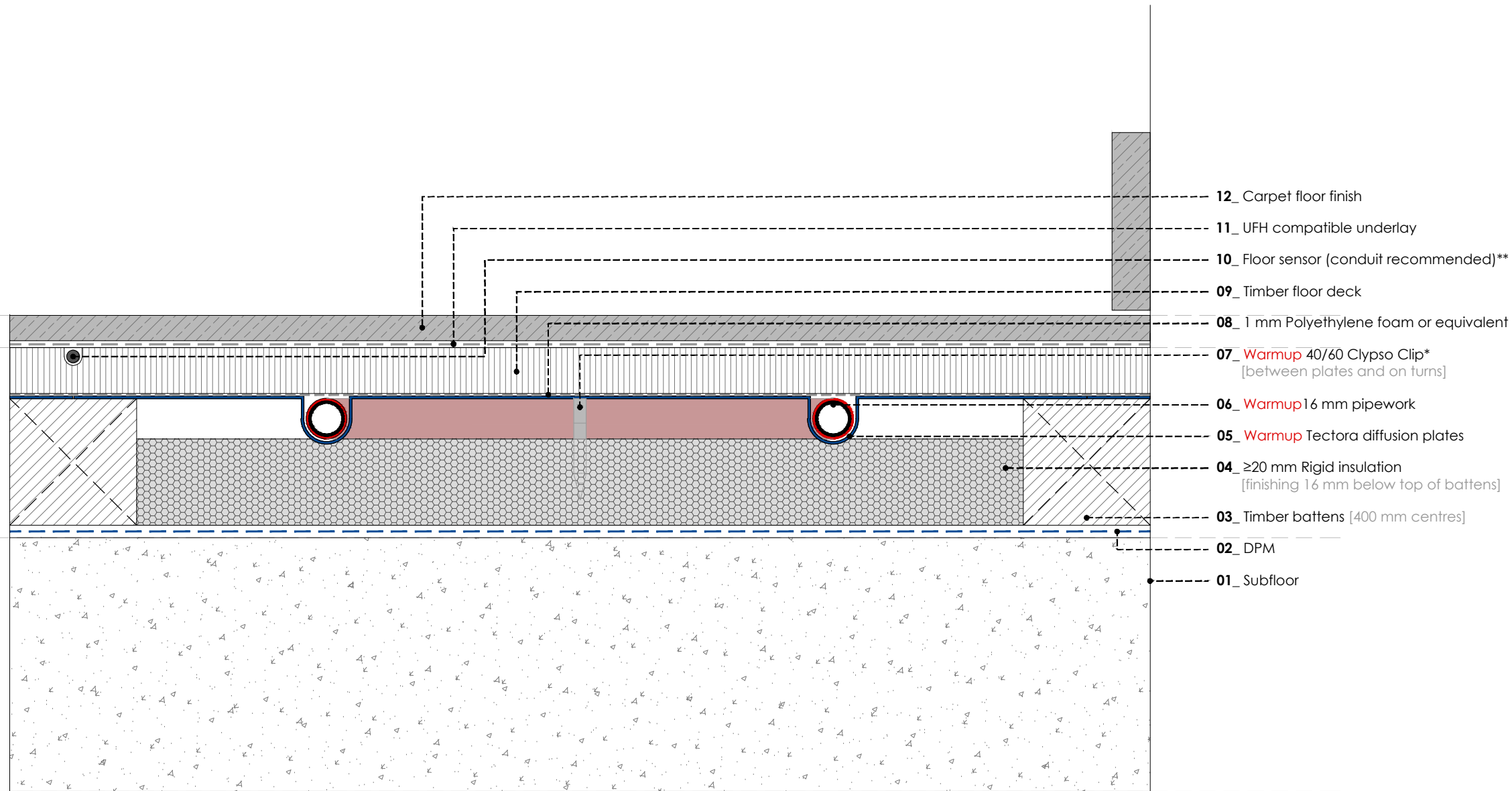

- 12\_ Carpet floor finish
- 11\_ UFH compatible underlay
- 10\_ Floor sensor (conduit recommended)\*\*
- 09\_ Timber floor deck
- 08\_ 1 mm Polyethylene foam or equivalent
- 07\_ Warmup 40/60 Clypso Clip\*  
[between plates and on turns]
- 06\_ Warmup 16 mm pipework
- 05\_ Warmup Tectora diffusion plates
- 04\_ ≥20 mm Rigid insulation  
[finishing 16 mm below top of battens]
- 03\_ Timber battens [400 mm centres]
- 02\_ DPM
- 01\_ Subfloor

REV	DATE	DESCRIPTION	DR	CH



# Warmup

The world's **best-selling** floor heating brand™

WARMUP PLC, 704 Tudor Estate, Abbey Road, London, NW10 7UW  
 Tel 0845 034 8270 Fax 0208 453 6869  
[cad@warmup.com](mailto:cad@warmup.com) [projects@warmup.com](mailto:projects@warmup.com) [www.warmup.co.uk](http://www.warmup.co.uk)

<b>DRAWING ISSUE STATUS</b>		<b>DRAWING NO</b>
<b>CONSTRUCTION</b>		08
<b>PROJECT</b>		
<b>TECTORA JOISTED BATTEN FLOOR SYSTEM</b>		
<b>CONCRETE SUBFLOOR</b>		
<b>TITLE</b>		
<b>CARPET FLOOR</b>		
<b>DETAILED SECTION</b>		
<b>PROJECT MANAGER</b>	<b>DRAWN</b>	<b>CHECKED</b>
	AA	AW
<b>DATE</b>	<b>SCALE</b>	<b>REVISION</b>
01.03.2017	1:50@A3	
<b>CAD FILE</b>		
20170228-H-TECTORA-DET SECTIONS.DWG		

## WARMUP TECTORA JOISTED BATTEN FLOOR SYSTEM. Concrete subfloor. Carpet floor

- \* Pipes need to be clipped to the insulation on turns
- \*\* Channel a groove in the floor deck to allow for floor sensor installation

© This drawing is confidential and may not be used, copied or disclosed to anyone without permission of Warmup Plc. The Copyright of these drawings remain the property of Warmup Plc.

Do not scale from drawings, all dimensions to be checked on site.

The Warmup word and associated logos are trade marks. © Warmup Plc. 2010 - Regd. TM Nos. 1257757, 4409926, 5265707. E & OE. Registered in England No. 2955213.