

REV	DATE	DESCRIPTION	DR	CH



# Warmup

The world's **best-selling** floor heating brand™

WARMUP PLC, 704 Tudor Estate, Abbey Road, London, NW10 7UW  
 Tel 0845 034 8270 Fax 0208 453 6869  
[cad@warmup.com](mailto:cad@warmup.com) [projects@warmup.com](mailto:projects@warmup.com) [www.warmup.co.uk](http://www.warmup.co.uk)

<b>DRAWING ISSUE STATUS</b>		<b>DRAWING NO</b>
<b>CONSTRUCTION</b>		01
<b>PROJECT</b>		
<b>METRO RAIL SYSTEM</b>		
CONCRETE SUBFLOOR		
<b>TITLE</b>		
GENERIC TEMPLATE		
<b>DETAILED SECTION</b>		
<b>PROJECT MANAGER</b>	<b>DRAWN</b>	<b>CHECKED</b>
	AA	AW
<b>DATE</b>	<b>SCALE</b>	<b>REVISION</b>
20.02.2017	1:50@A3	
<b>CAD FILE</b>		
20170220-H-METRO-DET SECTIONS.DWG		

**WARMUP METRO RAIL SYSTEM. Generic template**

© This drawing is confidential and may not be used, copied or disclosed to anyone without permission of Warmup Plc. The Copyright of these drawings remain the property of Warmup Plc.

Do not scale from drawings, all dimensions to be checked on site.

The Warmup word and associated logos are trade marks. © Warmup Plc. 2010 - Regd. TM Nos. 1257757, 4409926, 5265707. E & OE. Registered in England No. 2955213.

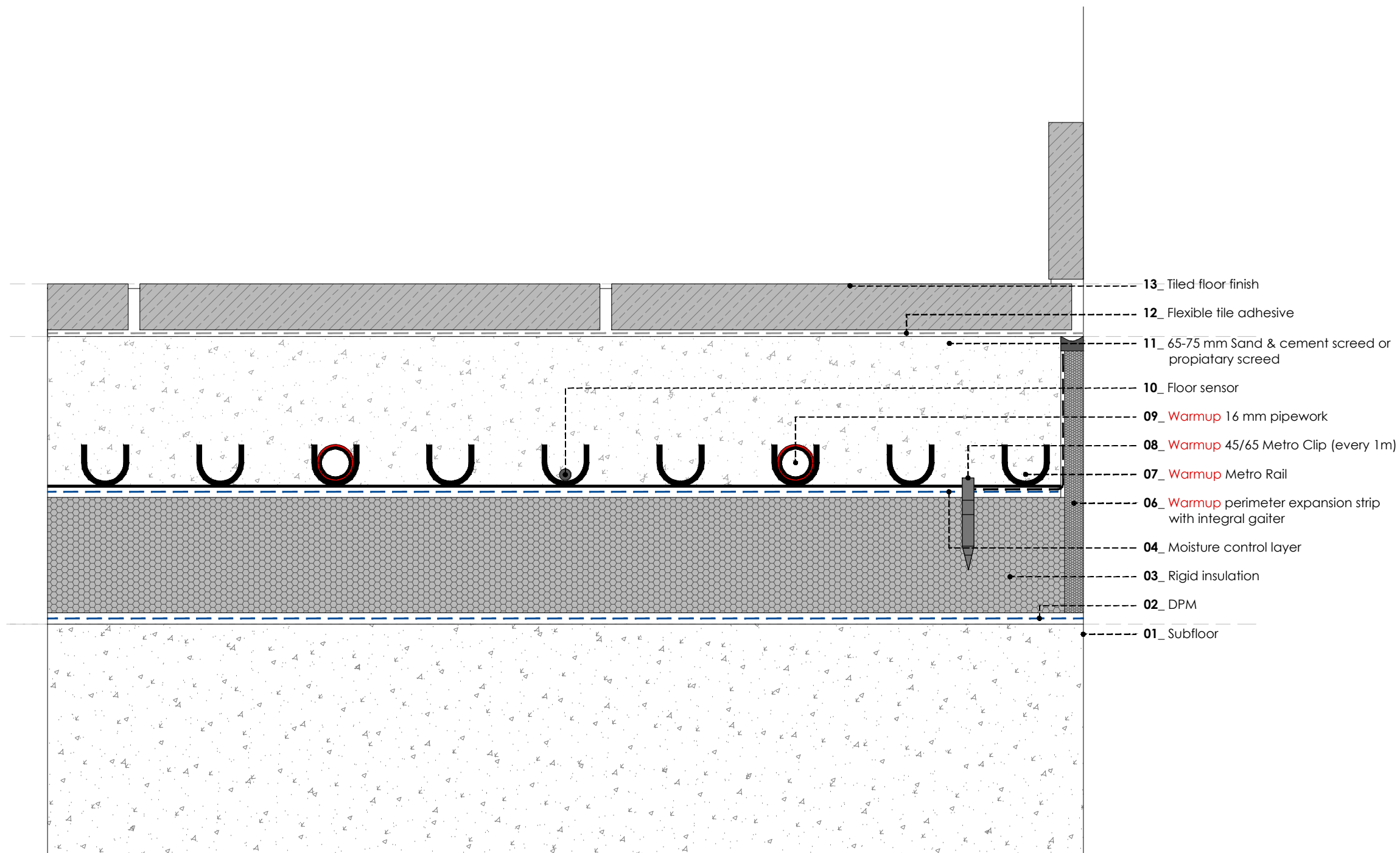

- 13\_ Tiled floor finish
- 12\_ Flexible tile adhesive
- 11\_ 65-75 mm Sand & cement screed or proprietary screed
- 10\_ Floor sensor
- 09\_ Warmup 16 mm pipework
- 08\_ Warmup 45/65 Metro Clip (every 1m)
- 07\_ Warmup Metro Rail
- 06\_ Warmup perimeter expansion strip with integral gaiter
- 04\_ Moisture control layer
- 03\_ Rigid insulation
- 02\_ DPM
- 01\_ Subfloor

REV	DATE	DESCRIPTION	DR	CH



# Warmup

The world's **best-selling** floor heating brand™

WARMUP PLC, 704 Tudor Estate, Abbey Road, London, NW10 7UW  
 Tel 0845 034 8270 Fax 0208 453 6869  
[cad@warmup.com](mailto:cad@warmup.com) [projects@warmup.com](mailto:projects@warmup.com) [www.warmup.co.uk](http://www.warmup.co.uk)

<b>DRAWING ISSUE STATUS</b>		<b>DRAWING NO</b>
<b>CONSTRUCTION</b>		02
<b>PROJECT</b>		
<b>METRO RAIL SYSTEM</b>		
<b>CONCRETE SUBFLOOR</b>		
<b>TITLE</b>		
<b>TILED FLOOR</b>		
<b>DETAILED SECTION</b>		
<b>PROJECT MANAGER</b>	<b>DRAWN</b>	<b>CHECKED</b>
	AA	AW
<b>DATE</b>	<b>SCALE</b>	<b>REVISION</b>
20.02.2017	1:50@A3	
<b>CAD FILE</b>		
20170220-H-METRO-DET SECTIONS.DWG		

**WARMUP METRO RAIL SYSTEM. Tiled floor**

© This drawing is confidential and may not be used, copied or disclosed to anyone without permission of Warmup Plc. The Copyright of these drawings remain the property of Warmup Plc.

Do not scale from drawings, all dimensions to be checked on site.

The Warmup word and associated logos are trade marks. © Warmup Plc. 2010 - Regd. TM Nos. 1257757, 4409926, 5265707. E & OE. Registered in England No. 2955213.

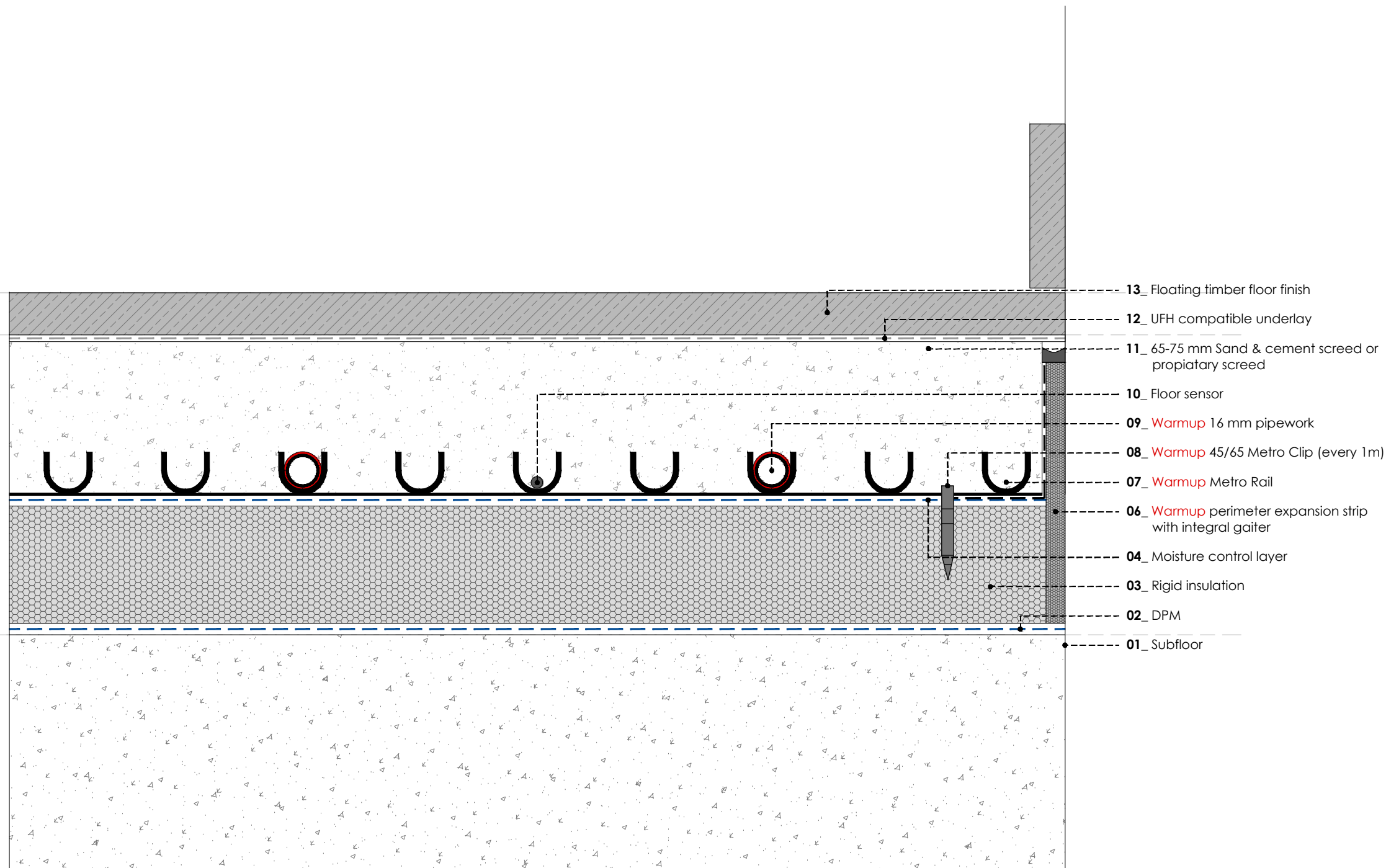

- 13\_ Floating timber floor finish
- 12\_ UFH compatible underlay
- 11\_ 65-75 mm Sand & cement screed or proprietary screed
- 10\_ Floor sensor
- 09\_ Warmup 16 mm pipework
- 08\_ Warmup 45/65 Metro Clip (every 1m)
- 07\_ Warmup Metro Rail
- 06\_ Warmup perimeter expansion strip with integral gaiter
- 04\_ Moisture control layer
- 03\_ Rigid insulation
- 02\_ DPM
- 01\_ Subfloor

REV	DATE	DESCRIPTION	DR	CH



# Warmup

The world's **best-selling** floor heating brand™

WARMUP PLC, 704 Tudor Estate, Abbey Road, London, NW10 7UW  
Tel 0845 034 8270 Fax 0208 453 6869  
cad@warmup.com projects@warmup.com www.warmup.co.uk

<b>DRAWING ISSUE STATUS</b>		<b>DRAWING NO</b>
<b>CONSTRUCTION</b>		03
<b>PROJECT</b>		
<b>METRO RAIL SYSTEM</b>		
<b>CONCRETE SUBFLOOR</b>		
<b>TITLE</b>		
<b>WOOD / LAMINATE FLOOR - FLOATING</b>		
<b>DETAILED SECTION</b>		
<b>PROJECT MANAGER</b>	<b>DRAWN</b>	<b>CHECKED</b>
	AA	AW
<b>DATE</b>	<b>SCALE</b>	<b>REVISION</b>
20.02.2017	1:50@A3	
<b>CAD FILE</b>		
20170220-H-METRO-DET SECTIONS.DWG		

**WARMUP METRO RAIL SYSTEM. Wood / Laminate floor - floating**

© This drawing is confidential and may not be used, copied or disclosed to anyone without permission of Warmup Plc. The Copyright of these drawings remain the property of Warmup Plc.

Do not scale from drawings, all dimensions to be checked on site.

The Warmup word and associated logos are trade marks. © Warmup Plc. 2010 - Regd. TM Nos. 1257757, 4409926, 5265707. E & OE. Registered in England No. 2955213.

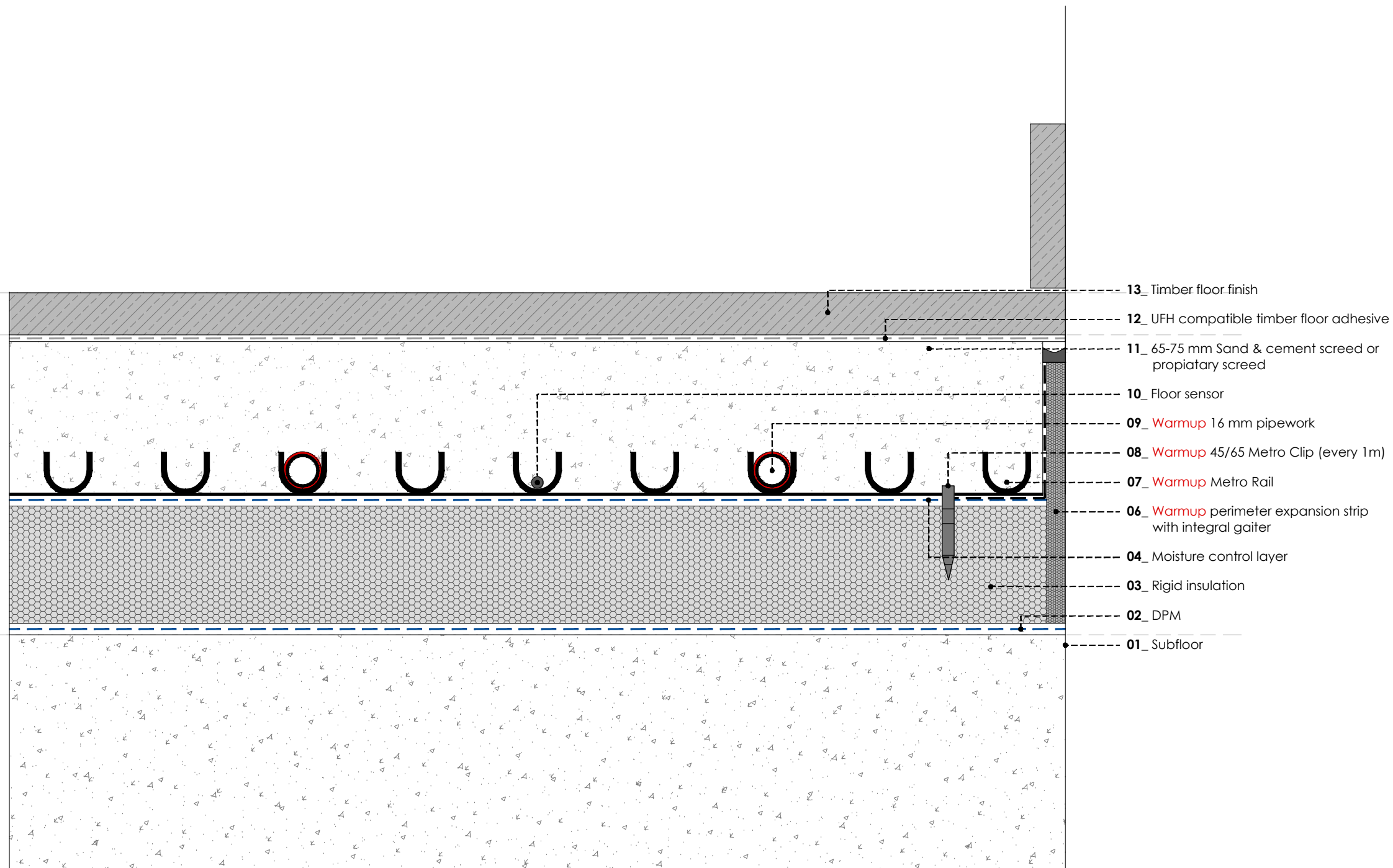

- 13\_ Timber floor finish
- 12\_ UFH compatible timber floor adhesive
- 11\_ 65-75 mm Sand & cement screed or proprietary screed
- 10\_ Floor sensor
- 09\_ Warmup 16 mm pipework
- 08\_ Warmup 45/65 Metro Clip (every 1m)
- 07\_ Warmup Metro Rail
- 06\_ Warmup perimeter expansion strip with integral gaiter
- 04\_ Moisture control layer
- 03\_ Rigid insulation
- 02\_ DPM
- 01\_ Subfloor

REV	DATE	DESCRIPTION	DR	CH



# Warmup

The world's **best-selling** floor heating brand™

WARMUP PLC, 704 Tudor Estate, Abbey Road, London, NW10 7UW  
 Tel 0845 034 8270 Fax 0208 453 6869  
[cad@warmup.com](mailto:cad@warmup.com) [projects@warmup.com](mailto:projects@warmup.com) [www.warmup.co.uk](http://www.warmup.co.uk)

<b>DRAWING ISSUE STATUS</b>		<b>DRAWING NO</b>
<b>CONSTRUCTION</b>		04
<b>PROJECT</b>		
<b>METRO RAIL SYSTEM</b>		
CONCRETE SUBFLOOR		
<b>TITLE</b>		
WOOD / LAMINATE FLOOR - GLUED		
<b>DETAILED SECTION</b>		
<b>PROJECT MANAGER</b>	<b>DRAWN</b>	<b>CHECKED</b>
	AA	AW
<b>DATE</b>	<b>SCALE</b>	<b>REVISION</b>
20.02.2017	1:50@A3	
<b>CAD FILE</b>		
20170220-H-METRO-DET SECTIONS.DWG		

**WARMUP METRO RAIL SYSTEM. Wood / Laminate floor - glued**

© This drawing is confidential and may not be used, copied or disclosed to anyone without permission of Warmup Plc. The Copyright of these drawings remain the property of Warmup Plc.

Do not scale from drawings, all dimensions to be checked on site.

The Warmup word and associated logos are trade marks. © Warmup Plc. 2010 - Regd. TM Nos. 1257757, 4409926, 5265707. E & OE. Registered in England No. 2955213.

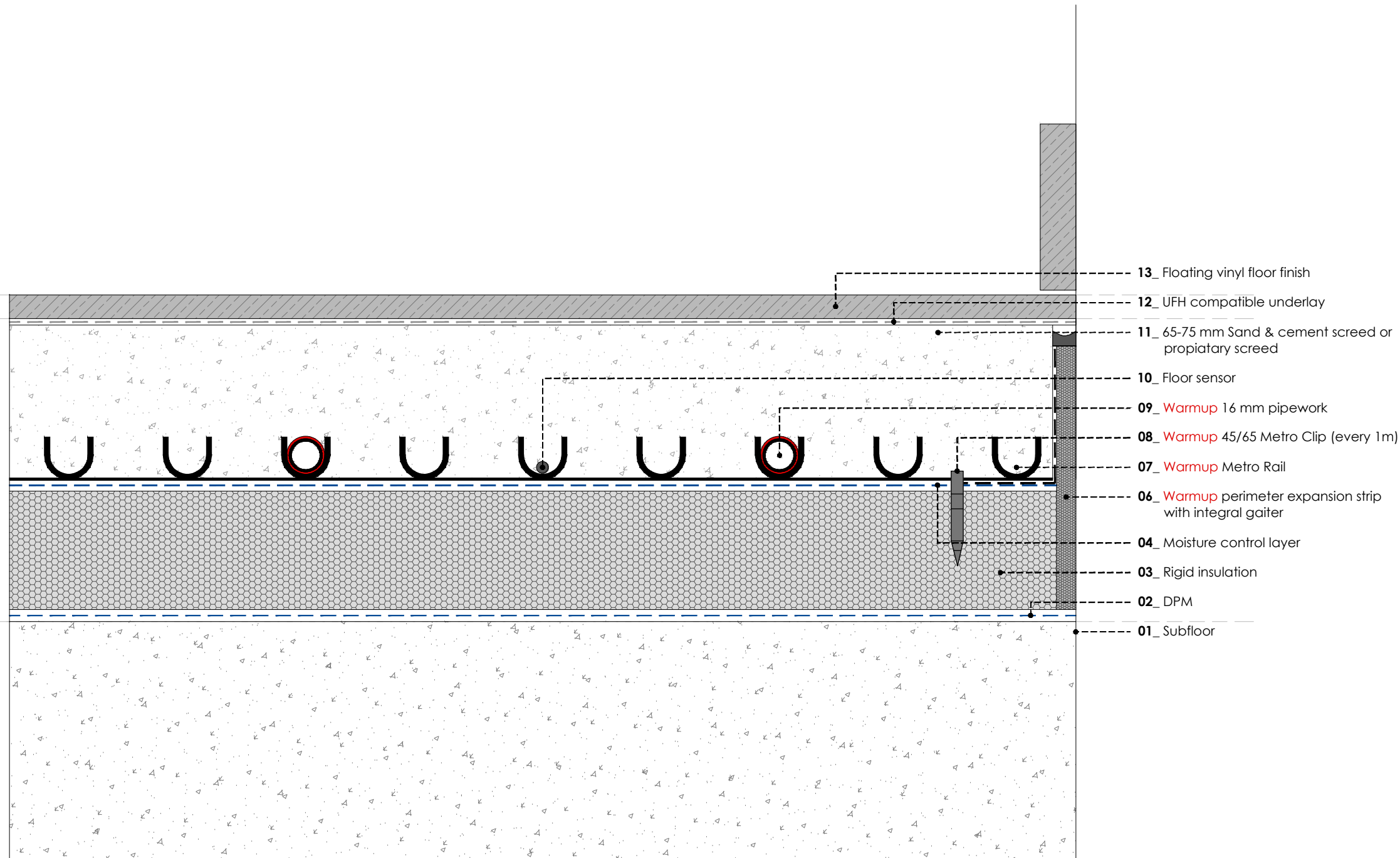

- 13\_ Floating vinyl floor finish
- 12\_ UFH compatible underlay
- 11\_ 65-75 mm Sand & cement screed or proprietary screed
- 10\_ Floor sensor
- 09\_ Warmup 16 mm pipework
- 08\_ Warmup 45/65 Metro Clip (every 1m)
- 07\_ Warmup Metro Rail
- 06\_ Warmup perimeter expansion strip with integral gaiter
- 04\_ Moisture control layer
- 03\_ Rigid insulation
- 02\_ DPM
- 01\_ Subfloor

REV	DATE	DESCRIPTION	DR	CH



# Warmup

The world's **best-selling** floor heating brand™

WARMUP PLC, 704 Tudor Estate, Abbey Road, London, NW10 7UW  
 Tel 0845 034 8270 Fax 0208 453 6869  
[cad@warmup.com](mailto:cad@warmup.com) [projects@warmup.com](mailto:projects@warmup.com) [www.warmup.co.uk](http://www.warmup.co.uk)

<b>DRAWING ISSUE STATUS</b>		<b>DRAWING NO</b>
<b>CONSTRUCTION</b>		05
<b>PROJECT</b>		
<b>METRO RAIL SYSTEM</b>		
CONCRETE SUBFLOOR		
<b>TITLE</b>		
VINYL FLOOR - FLOATING		
<b>DETAILED SECTION</b>		
<b>PROJECT MANAGER</b>	<b>DRAWN</b>	<b>CHECKED</b>
	AA	AW
<b>DATE</b>	<b>SCALE</b>	<b>REVISION</b>
20.02.2017	1:50@A3	
<b>CAD FILE</b>		
20170220-H-METRO-DET SECTIONS.DWG		

**WARMUP METRO RAIL SYSTEM. Vinyl floor - floating**

© This drawing is confidential and may not be used, copied or disclosed to anyone without permission of Warmup Plc. The Copyright of these drawings remain the property of Warmup Plc.

Do not scale from drawings, all dimensions to be checked on site.

The Warmup word and associated logos are trade marks. © Warmup Plc. 2010 - Regd. TM Nos. 1257757, 4409926, 5265707. E & OE. Registered in England No. 2955213.

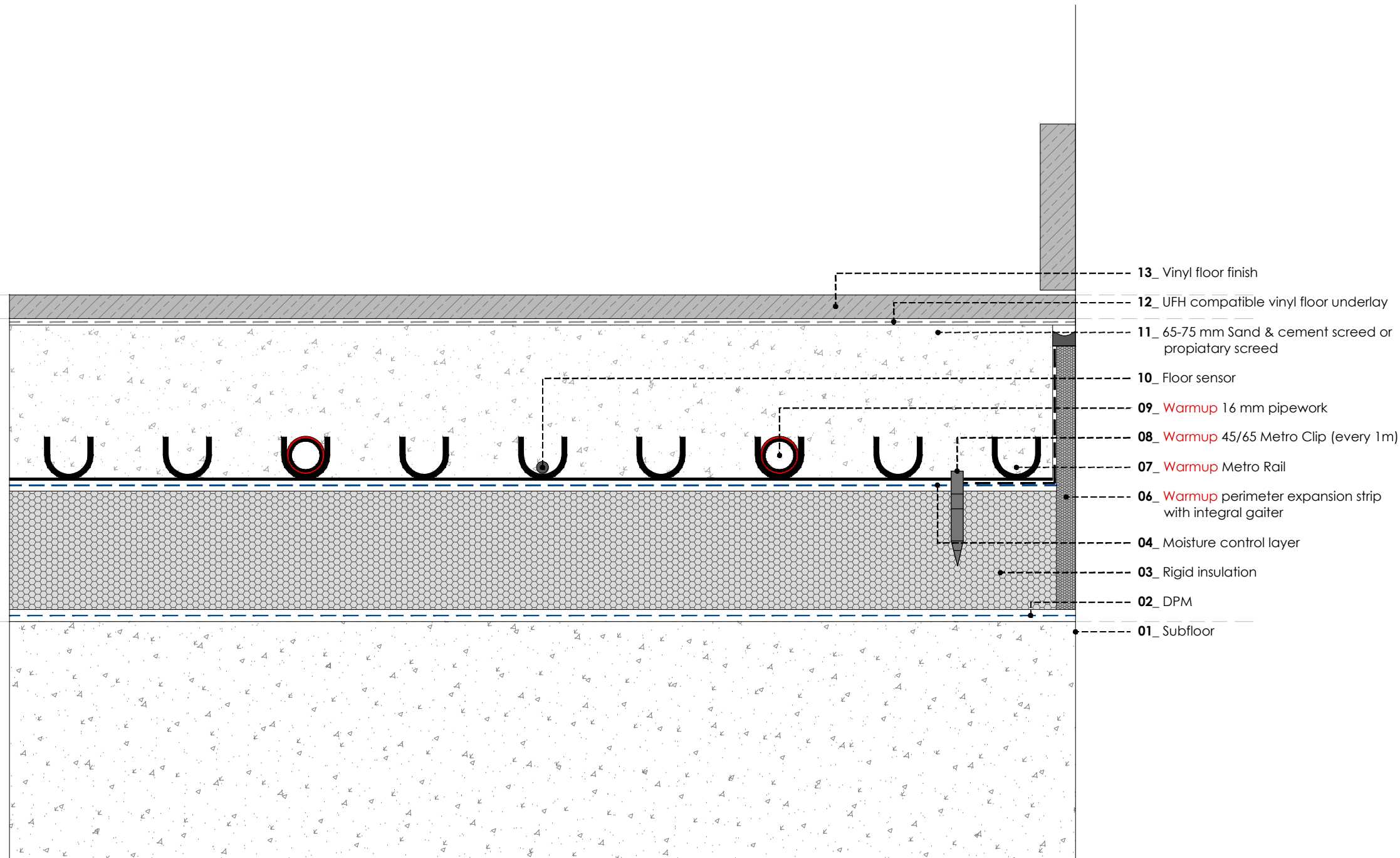

REV	DATE	DESCRIPTION	DR	CH



# Warmup

The world's **best-selling** floor heating brand™

WARMUP PLC, 704 Tudor Estate, Abbey Road, London, NW10 7UW  
 Tel 0845 034 8270 Fax 0208 453 6869  
[cad@warmup.com](mailto:cad@warmup.com) [projects@warmup.com](mailto:projects@warmup.com) [www.warmup.co.uk](http://www.warmup.co.uk)

<b>DRAWING ISSUE STATUS</b>		<b>DRAWING NO</b>
<b>CONSTRUCTION</b>		06
<b>PROJECT</b>		
<b>METRO RAIL SYSTEM</b>		
CONCRETE SUBFLOOR		
<b>TITLE</b>		
VINYL FLOOR - GLUED		
<b>DETAILED SECTION</b>		
<b>PROJECT MANAGER</b>	<b>DRAWN</b>	<b>CHECKED</b>
	AA	AW
<b>DATE</b>	<b>SCALE</b>	<b>REVISION</b>
20.02.2017	1:50@A3	
<b>CAD FILE</b>		
20170220-H-METRO-DET SECTIONS.DWG		

**WARMUP METRO RAIL SYSTEM. Vinyl floor - glued**

© This drawing is confidential and may not be used, copied or disclosed to anyone without permission of Warmup Plc. The Copyright of these drawings remain the property of Warmup Plc.

Do not scale from drawings, all dimensions to be checked on site.

The Warmup word and associated logos are trade marks. © Warmup Plc. 2010 - Regd. TM Nos. 1257757, 4409926, 5265707. E & OE. Registered in England No. 2955213.

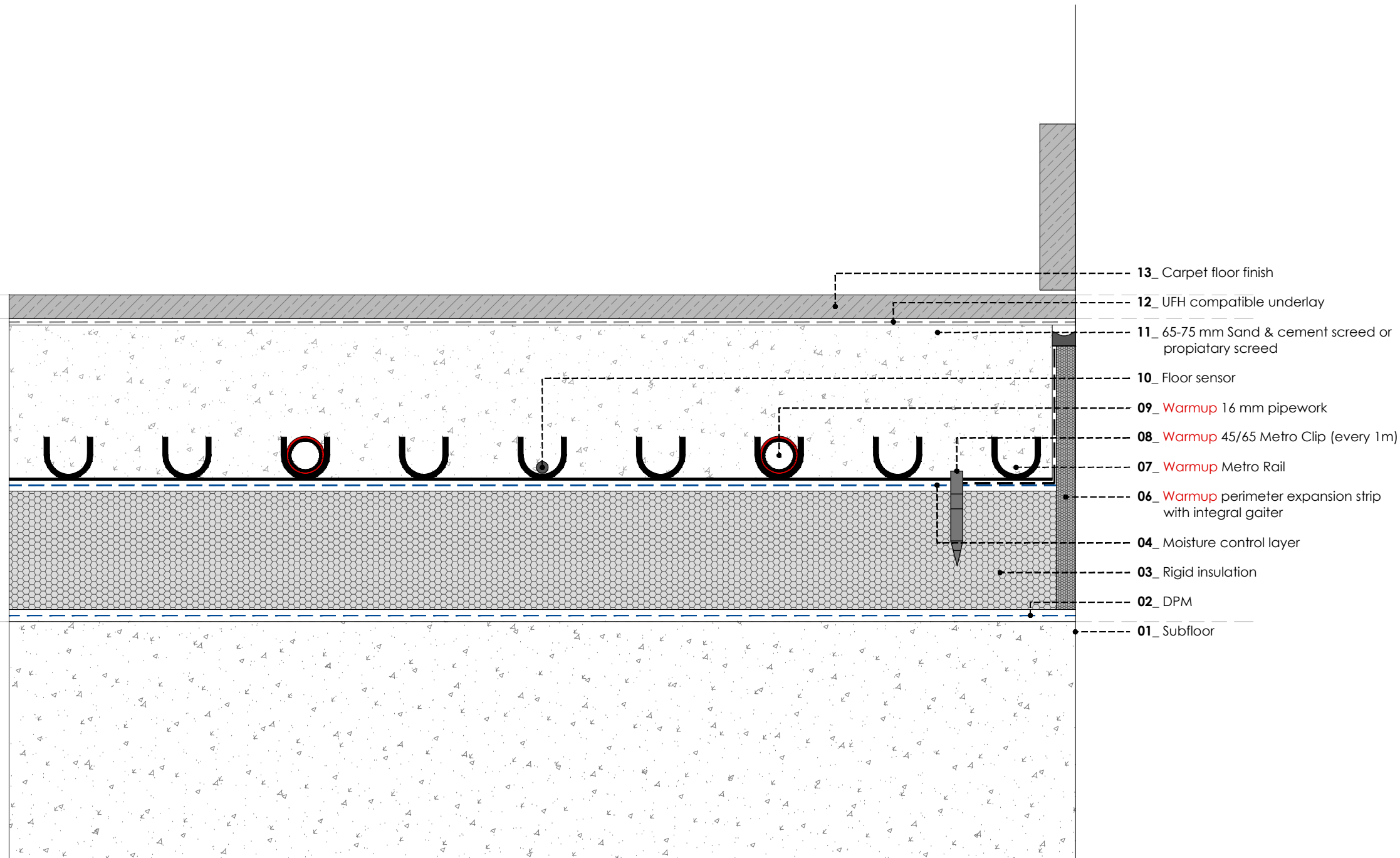

- 13\_ Carpet floor finish
- 12\_ UFH compatible underlay
- 11\_ 65-75 mm Sand & cement screed or proprietary screed
- 10\_ Floor sensor
- 09\_ Warmup 16 mm pipework
- 08\_ Warmup 45/65 Metro Clip (every 1m)
- 07\_ Warmup Metro Rail
- 06\_ Warmup perimeter expansion strip with integral gaiter
- 04\_ Moisture control layer
- 03\_ Rigid insulation
- 02\_ DPM
- 01\_ Subfloor

REV	DATE	DESCRIPTION	DR	CH



# Warmup

The world's **best-selling** floor heating brand™

WARMUP PLC, 704 Tudor Estate, Abbey Road, London, NW10 7UW  
 Tel 0845 034 8270 Fax 0208 453 6869  
[cad@warmup.com](mailto:cad@warmup.com) [projects@warmup.com](mailto:projects@warmup.com) [www.warmup.co.uk](http://www.warmup.co.uk)

<b>DRAWING ISSUE STATUS</b>		<b>DRAWING NO</b>
<b>CONSTRUCTION</b>		07
<b>PROJECT</b>		
METRO RAIL SYSTEM CONCRETE SUBFLOOR		
<b>TITLE</b>		
CARPET FLOOR <b>DETAILED SECTION</b>		
<b>PROJECT MANAGER</b>	<b>DRAWN</b>	<b>CHECKED</b>
	AA	AW
<b>DATE</b>	<b>SCALE</b>	<b>REVISION</b>
20.02.2017	1:50@A3	
<b>CAD FILE</b>		
20170220-H-METRO-DET SECTIONS.DWG		

**WARMUP METRO RAIL SYSTEM. Carpet floor**

© This drawing is confidential and may not be used, copied or disclosed to anyone without permission of Warmup Plc. The Copyright of these drawings remain the property of Warmup Plc.

Do not scale from drawings, all dimensions to be checked on site.

The Warmup word and associated logos are trade marks. © Warmup Plc. 2010 - Regd. TM Nos. 1257757, 4409926, 5265707. E & OE. Registered in England No. 2955213.