

- 11_ Floor finish and intermediate layer
- 10_ Floor sensor (conduit recommended)**
- 09_ Warmup diffusion plates
- 08_ Warmup 16 mm pipework
- 07_ Warmup perimeter expansion strip
- 06_ 55 mm countersunk chipboard screws
- 05_ 22 mm Warmup Econna Boards
- 04_ Service pipe [insulated]
- 03_ Service void
- 02_ Insulation
- 01_ Timber Joists *

REV	DATE	DESCRIPTION	DR	CH



Warmup

The world's best-selling floor heating brand™

WARMUP PLC, 704 Tudor Estate, Abbey Road, London, NW10 7UW
 Tel 0845 034 8270 Fax 0208 453 6869
cad@warmup.com projects@warmup.com www.warmup.co.uk

DRAWING ISSUE STATUS		DRAWING NO
CONSTRUCTION		01
PROJECT		
ECONNA JOISTED FLOOR SYSTEM		
TIMBER SUBFLOOR		
TITLE		
GENERIC TEMPLATE		
DETAILED SECTION		
PROJECT MANAGER	DRAWN	CHECKED
	AA	AW
DATE	SCALE	REVISION
28.02.2017	1:50@A3	
CAD FILE		
20170228-H-ECONNA-DET SECTIONS.DWG		

WARMUP ECONNA JOISTED FLOOR SYSTEM. Timber subfloor. Generic template

* Maximum joist spacing c/c is 600mm.

** The aluminium plates should be trimmed to allow 50mm spacing between the sensor and the diffuser plates.

© This drawing is confidential and may not be used, copied or disclosed to anyone without permission of Warmup Plc. The Copyright of these drawings remain the property of Warmup Plc.

Do not scale from drawings, all dimensions to be checked on site.

The Warmup word and associated logos are trade marks. © Warmup Plc. 2010 - Regd. TM Nos. 1257757, 4409926, 5265707. E & OE. Registered in England No. 2955213.

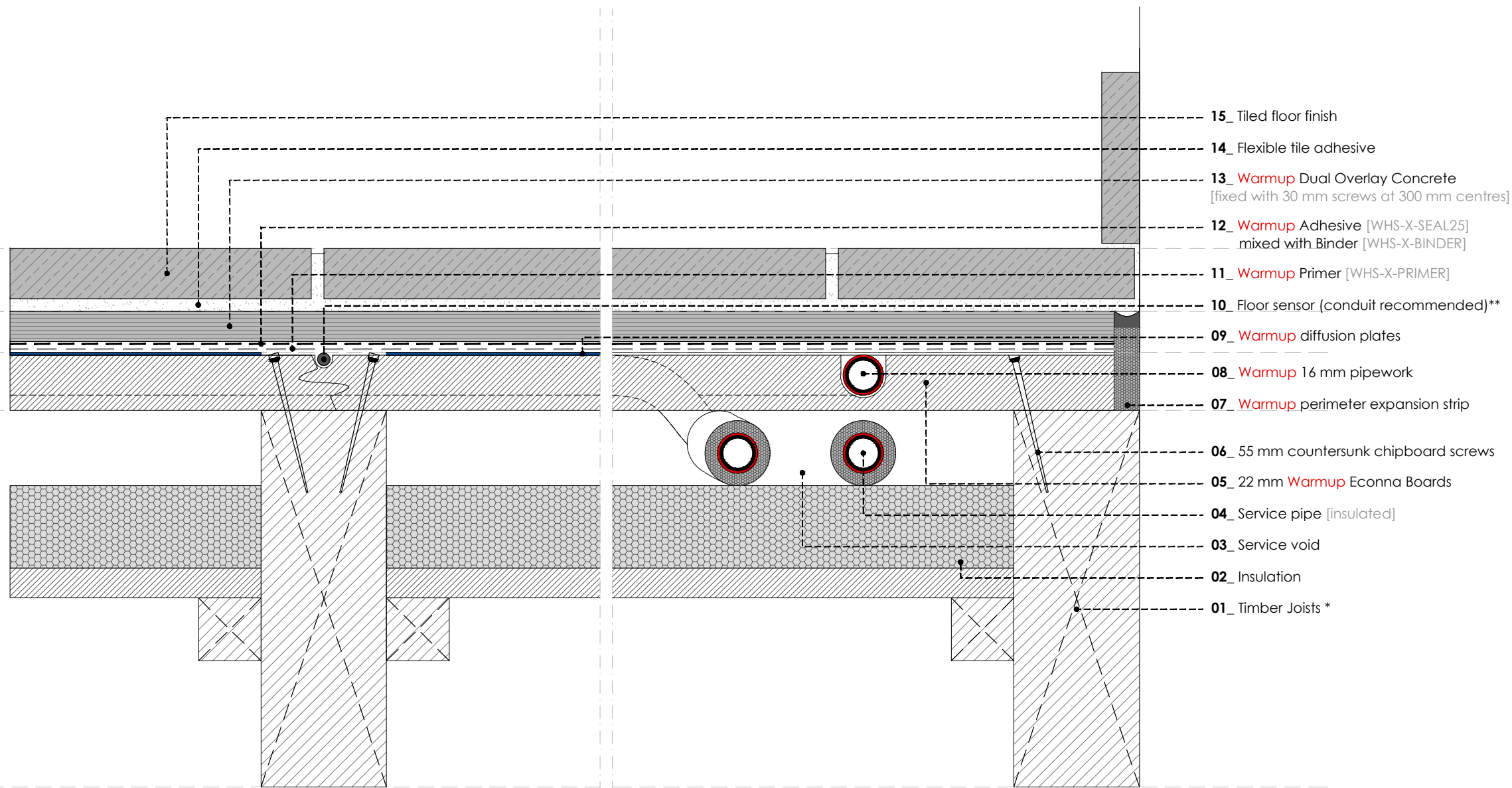

REV	DATE	DESCRIPTION	DR	CH



Warmup

The world's best-selling floor heating brand™

WARMUP PLC, 704 Tudor Estate, Abbey Road, London, NW10 7UW
 Tel 0845 034 8270 Fax 0208 453 6869
cad@warmup.com projects@warmup.com www.warmup.co.uk

DRAWING ISSUE STATUS		DRAWING NO
CONSTRUCTION		02
PROJECT		
ECONNA JOISTED FLOOR SYSTEM		
TIMBER SUBFLOOR		
TITLE		
TILED FLOOR		
DETAILED SECTION		
PROJECT MANAGER	DRAWN	CHECKED
	AA	AW
DATE	SCALE	REVISION
28.02.2017	1:50@A3	
CAD FILE		
20170228-H-ECONNA-DET SECTIONS.DWG		

WARMUP ECONNA JOISTED FLOOR SYSTEM. Timber subfloor. Tiled floor

* Maximum joist spacing c/c is 300mm if intended floor finish is tile.

** The aluminium plates should be trimmed to allow 50mm spacing between the sensor and the diffuser plates.

© This drawing is confidential and may not be used, copied or disclosed to anyone without permission of Warmup Plc. The Copyright of these drawings remain the property of Warmup Plc.

Do not scale from drawings, all dimensions to be checked on site.

The Warmup word and associated logos are trade marks. © Warmup Plc. 2010 - Regd. TM Nos. 1257757, 4409926, 5265707. E & OE. Registered in England No. 2955213.

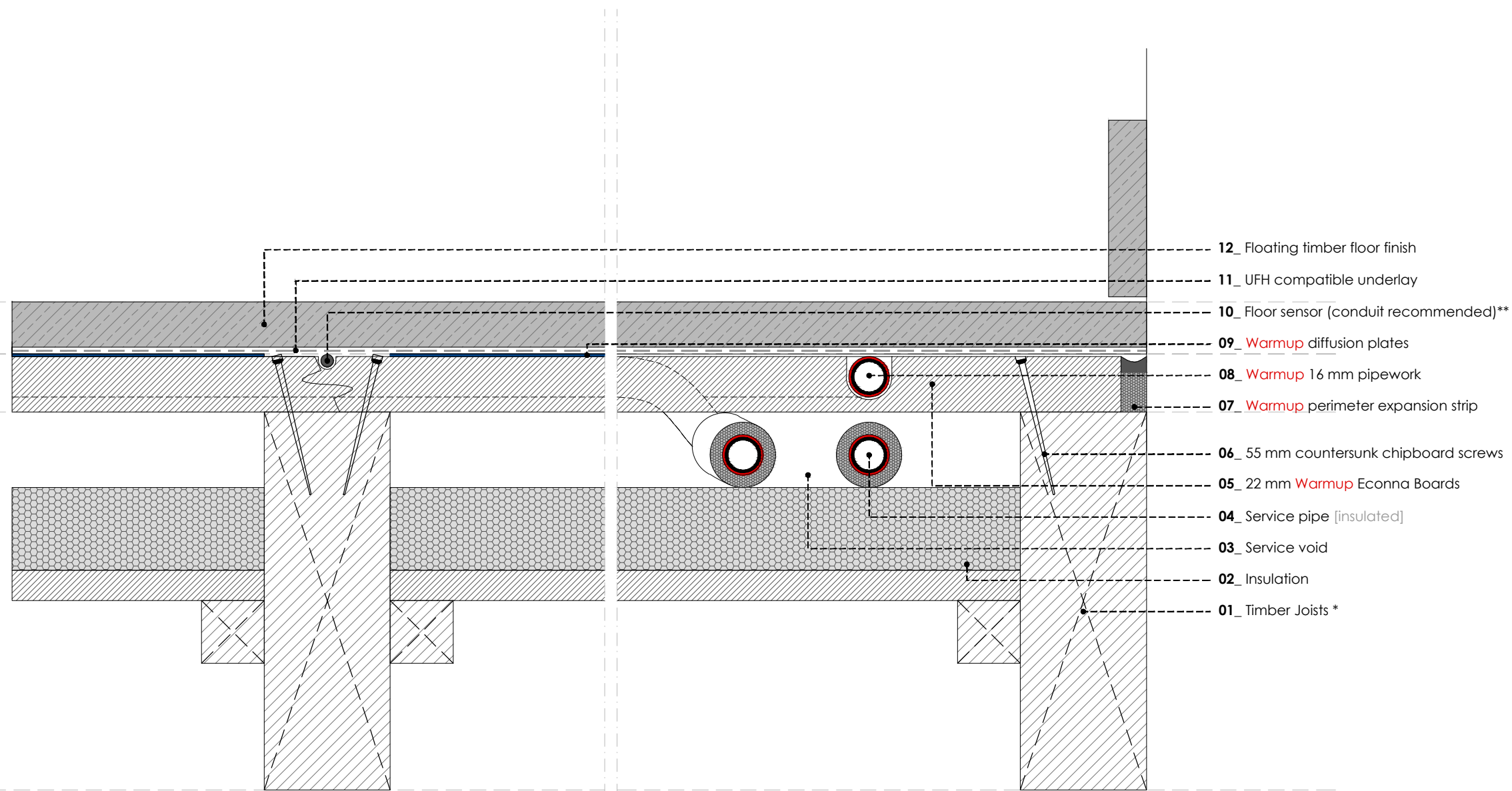

- 12_ Floating timber floor finish
- 11_ UFH compatible underlay
- 10_ Floor sensor (conduit recommended)**
- 09_ Warmup diffusion plates
- 08_ Warmup 16 mm pipework
- 07_ Warmup perimeter expansion strip
- 06_ 55 mm countersunk chipboard screws
- 05_ 22 mm Warmup Econna Boards
- 04_ Service pipe [insulated]
- 03_ Service void
- 02_ Insulation
- 01_ Timber Joists *

REV	DATE	DESCRIPTION	DR	CH



Warmup

The world's **best-selling** floor heating brand™

WARMUP PLC, 704 Tudor Estate, Abbey Road, London, NW10 7UW
Tel 0845 034 8270 Fax 0208 453 6869
cad@warmup.com projects@warmup.com www.warmup.co.uk

DRAWING ISSUE STATUS		DRAWING NO
CONSTRUCTION		03
PROJECT		
ECONNA JOISTED FLOOR SYSTEM		
TIMBER SUBFLOOR		
TITLE		
14-25mm WOOD/LAM. FLOOR-FLOATING		
DETAILED SECTION		
PROJECT MANAGER	DRAWN	CHECKED
	AA	AW
DATE	SCALE	REVISION
28.02.2017	1:50@A3	
CAD FILE		
20170228-H-ECONNA-DET SECTIONS.DWG		

WARMUP ECONNA JOISTED FLOOR SYSTEM. Timber subfloor. 14-25 mm Wood / Laminate Floor - Floating

* Maximum joist spacing c/c is 600mm.
 ** The aluminium plates should be trimmed to allow 50mm spacing between the sensor and the diffuser plates.

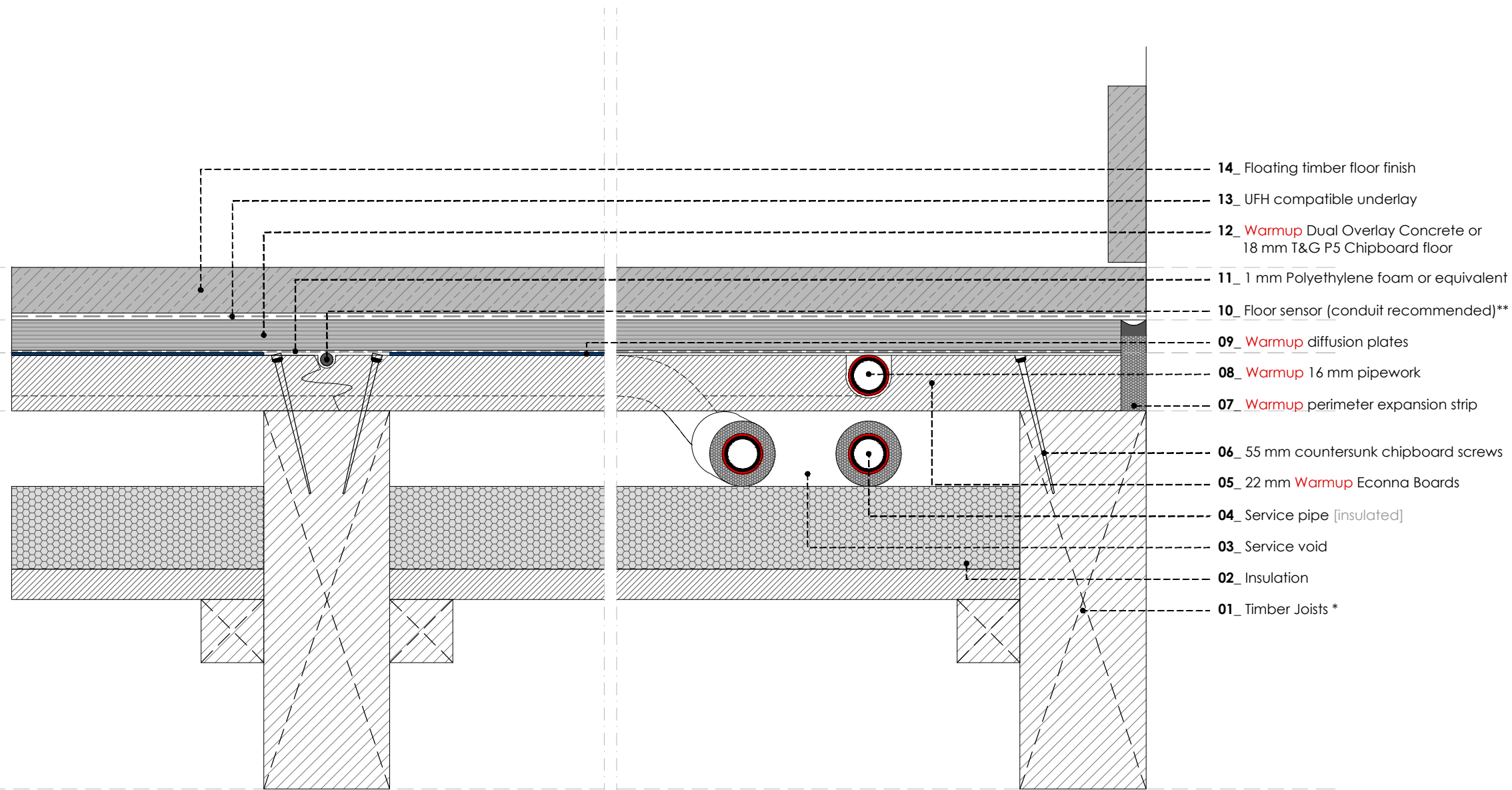

- 14_ Floating timber floor finish
- 13_ UFH compatible underlay
- 12_ Warmup Dual Overlay Concrete or 18 mm T&G P5 Chipboard floor
- 11_ 1 mm Polyethylene foam or equivalent
- 10_ Floor sensor (conduit recommended)**
- 09_ Warmup diffusion plates
- 08_ Warmup 16 mm pipework
- 07_ Warmup perimeter expansion strip
- 06_ 55 mm countersunk chipboard screws
- 05_ 22 mm Warmup Econna Boards
- 04_ Service pipe [insulated]
- 03_ Service void
- 02_ Insulation
- 01_ Timber Joists *

WARMUP ECONNA JOISTED FLOOR SYSTEM. Timber subfloor. Wood / Laminate Floor less than 14 mm

* Maximum joist spacing c/c is 600mm.

** The aluminium plates should be trimmed to allow 50mm spacing between the sensor and the diffuser plates.

REV	DATE	DESCRIPTION	DR	CH



Warmup

The world's **best-selling** floor heating brand™

WARMUP PLC, 704 Tudor Estate, Abbey Road, London, NW10 7UW
 Tel 0845 034 8270 Fax 0208 453 6869
cad@warmup.com projects@warmup.com www.warmup.co.uk

DRAWING ISSUE STATUS		DRAWING NO
CONSTRUCTION		04
PROJECT		
ECONNA JOISTED FLOOR SYSTEM		
TIMBER SUBFLOOR		
TITLE		
WOOD / LAMINATE FLOOR <14mm		
DETAILED SECTION		
PROJECT MANAGER	DRAWN	CHECKED
	AA	AW
DATE	SCALE	REVISION
28.02.2017	1:50@A3	
CAD FILE		
20170228-H-ECONNA-DET SECTIONS.DWG		

© This drawing is confidential and may not be used, copied or disclosed to anyone without permission of Warmup Plc. The Copyright of these drawings remain the property of Warmup Plc.

Do not scale from drawings, all dimensions to be checked on site.

The Warmup word and associated logos are trade marks. © Warmup Plc. 2010 - Regd. TM Nos. 1257757, 4409926, 5265707. E & OE. Registered in England No. 2955213.

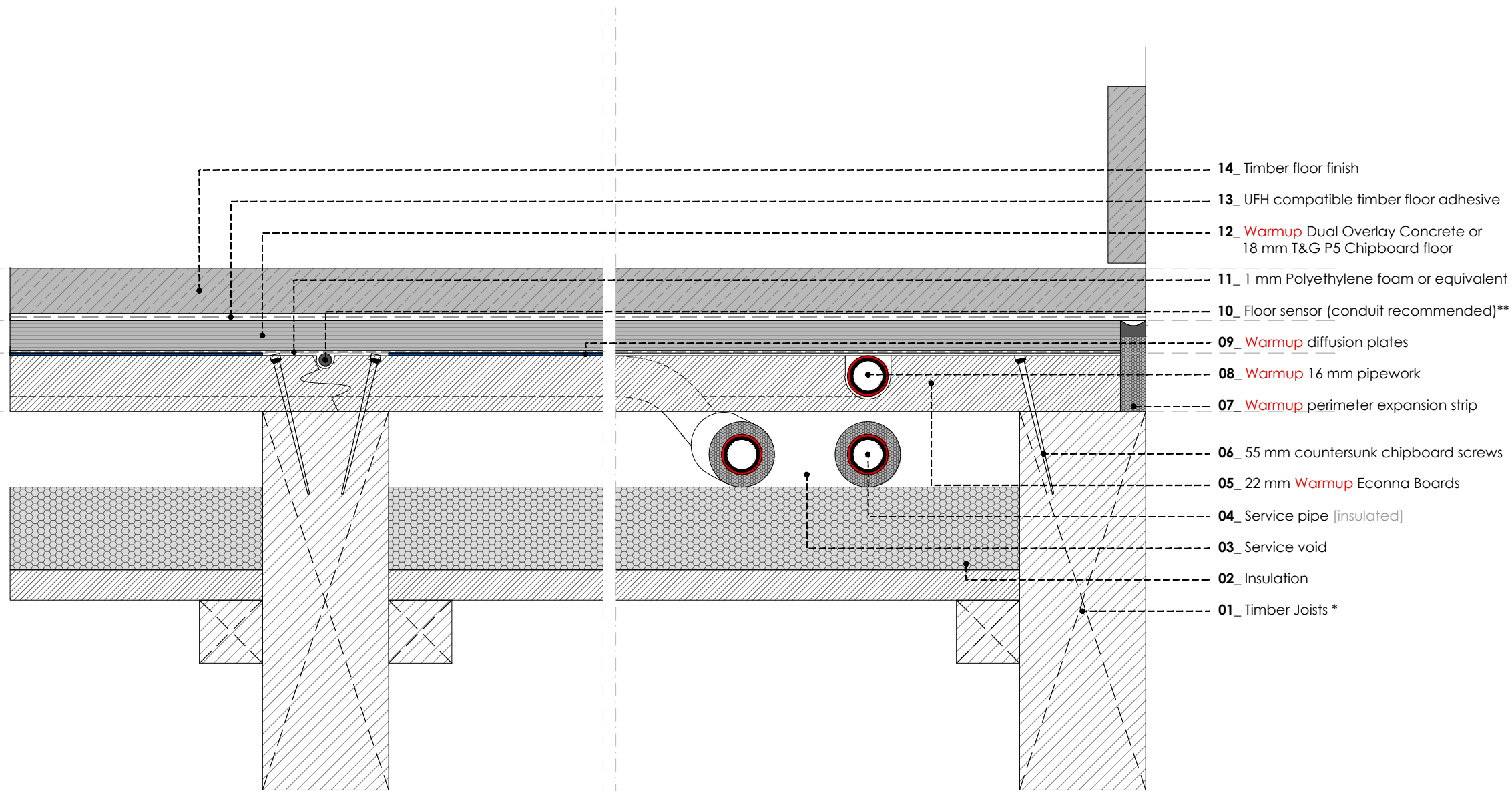

- 14_ Timber floor finish
- 13_ UFH compatible timber floor adhesive
- 12_ Warmup Dual Overlay Concrete or 18 mm T&G P5 Chipboard floor
- 11_ 1 mm Polyethylene foam or equivalent
- 10_ Floor sensor (conduit recommended)**
- 09_ Warmup diffusion plates
- 08_ Warmup 16 mm pipework
- 07_ Warmup perimeter expansion strip
- 06_ 55 mm countersunk chipboard screws
- 05_ 22 mm Warmup Econna Boards
- 04_ Service pipe [insulated]
- 03_ Service void
- 02_ Insulation
- 01_ Timber Joists *

WARMUP ECONNA JOISTED FLOOR SYSTEM. Timber subfloor. Wood / Laminate Floor - glued

* Maximum joist spacing c/c is 600mm.

** The aluminium plates should be trimmed to allow 50mm spacing between the sensor and the diffuser plates.

REV	DATE	DESCRIPTION	DR	CH



Warmup

The world's **best-selling** floor heating brand™

WARMUP PLC, 704 Tudor Estate, Abbey Road, London, NW10 7UW
Tel 0845 034 8270 Fax 0208 453 6869
cad@warmup.com projects@warmup.com www.warmup.co.uk

DRAWING ISSUE STATUS		DRAWING NO
CONSTRUCTION		05
PROJECT		
ECONNA JOISTED FLOOR SYSTEM		
TIMBER SUBFLOOR		
TITLE		
WOOD / LAMINATE FLOOR- GLUED		
DETAILED SECTION		
PROJECT MANAGER	DRAWN	CHECKED
	AA	AW
DATE	SCALE	REVISION
28.02.2017	1:50@A3	
CAD FILE		
20170228-H-ECONNA-DET SECTIONS.DWG		

© This drawing is confidential and may not be used, copied or disclosed to anyone without permission of Warmup Plc. The Copyright of these drawings remain the property of Warmup Plc.

Do not scale from drawings, all dimensions to be checked on site.

The Warmup word and associated logos are trade marks. © Warmup Plc. 2010 - Regd. TM Nos. 1257757, 4409926, 5265707. E & OE. Registered in England No. 2955213.

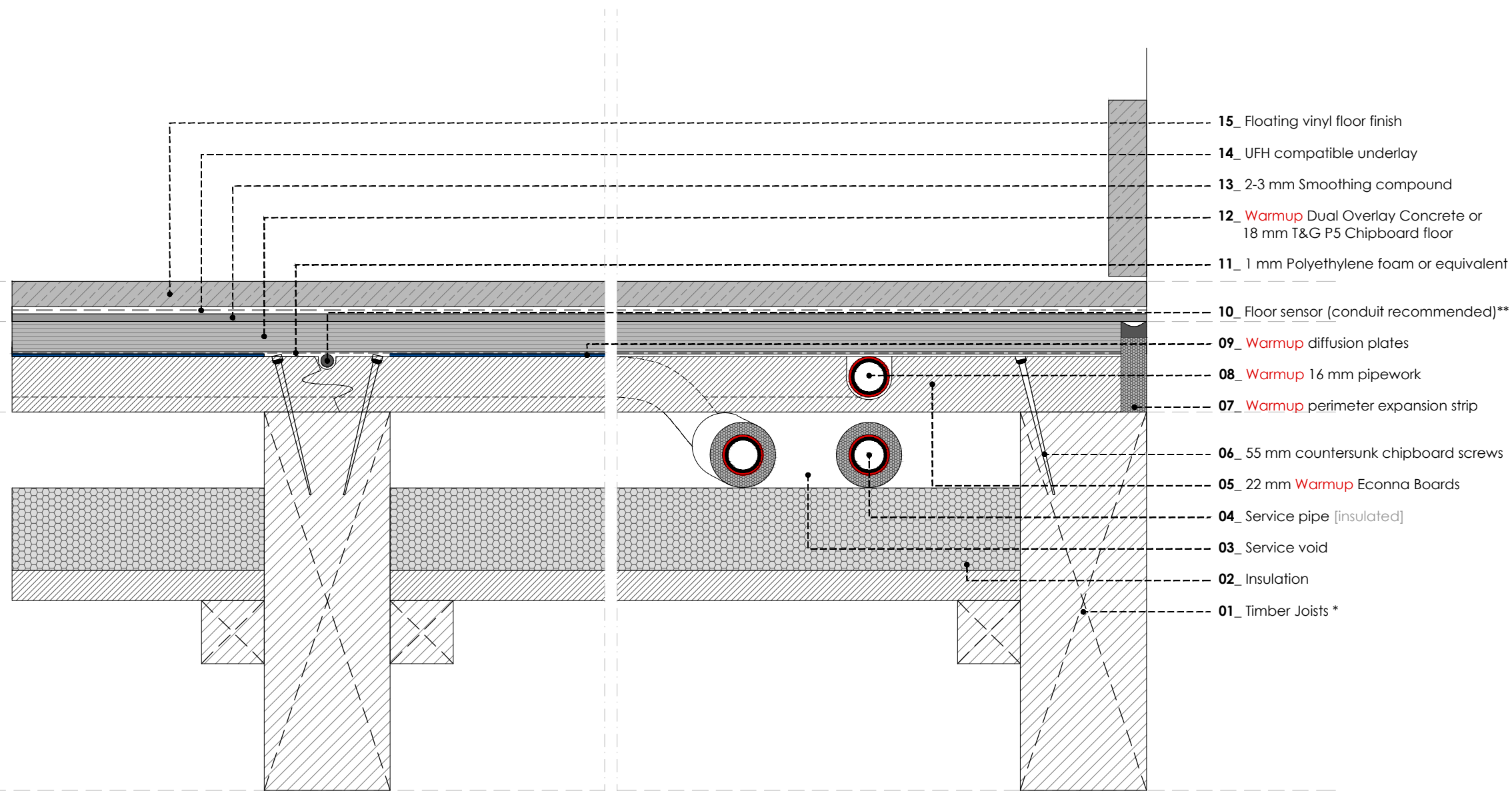

- 15_ Floating vinyl floor finish
- 14_ UFH compatible underlay
- 13_ 2-3 mm Smoothing compound
- 12_ Warmup Dual Overlay Concrete or 18 mm T&G P5 Chipboard floor
- 11_ 1 mm Polyethylene foam or equivalent
- 10_ Floor sensor (conduit recommended)**
- 09_ Warmup diffusion plates
- 08_ Warmup 16 mm pipework
- 07_ Warmup perimeter expansion strip
- 06_ 55 mm countersunk chipboard screws
- 05_ 22 mm Warmup Econna Boards
- 04_ Service pipe [insulated]
- 03_ Service void
- 02_ Insulation
- 01_ Timber Joists *

WARMUP ECONNA JOISTED FLOOR SYSTEM. Timber subfloor. Vinyl floor - floating

* Maximum joist spacing c/c is 600mm.
 ** The aluminium plates should be trimmed to allow 50mm spacing between the sensor and the diffuser plates.

REV	DATE	DESCRIPTION	DR	CH



The world's **best-selling** floor heating brand™

WARMUP PLC, 704 Tudor Estate, Abbey Road, London, NW10 7UW
 Tel 0845 034 8270 Fax 0208 453 6869
cad@warmup.com projects@warmup.com www.warmup.co.uk

DRAWING ISSUE STATUS		DRAWING NO
CONSTRUCTION		06
PROJECT		
ECONNA JOISTED FLOOR SYSTEM		
TIMBER SUBFLOOR		
TITLE		
VINYL FLOOR - FLOATING		
DETAILED SECTION		
PROJECT MANAGER	DRAWN	CHECKED
	AA	AW
DATE	SCALE	REVISION
28.02.2017	1:50@A3	
CAD FILE		
20170228-H-ECONNA-DET SECTIONS.DWG		

© This drawing is confidential and may not be used, copied or disclosed to anyone without permission of Warmup Plc. The Copyright of these drawings remain the property of Warmup Plc.

Do not scale from drawings, all dimensions to be checked on site.

The Warmup word and associated logos are trade marks. © Warmup Plc. 2010 - Regd. TM Nos. 1257757, 4409926, 5265707. E & OE. Registered in England No. 2955213.

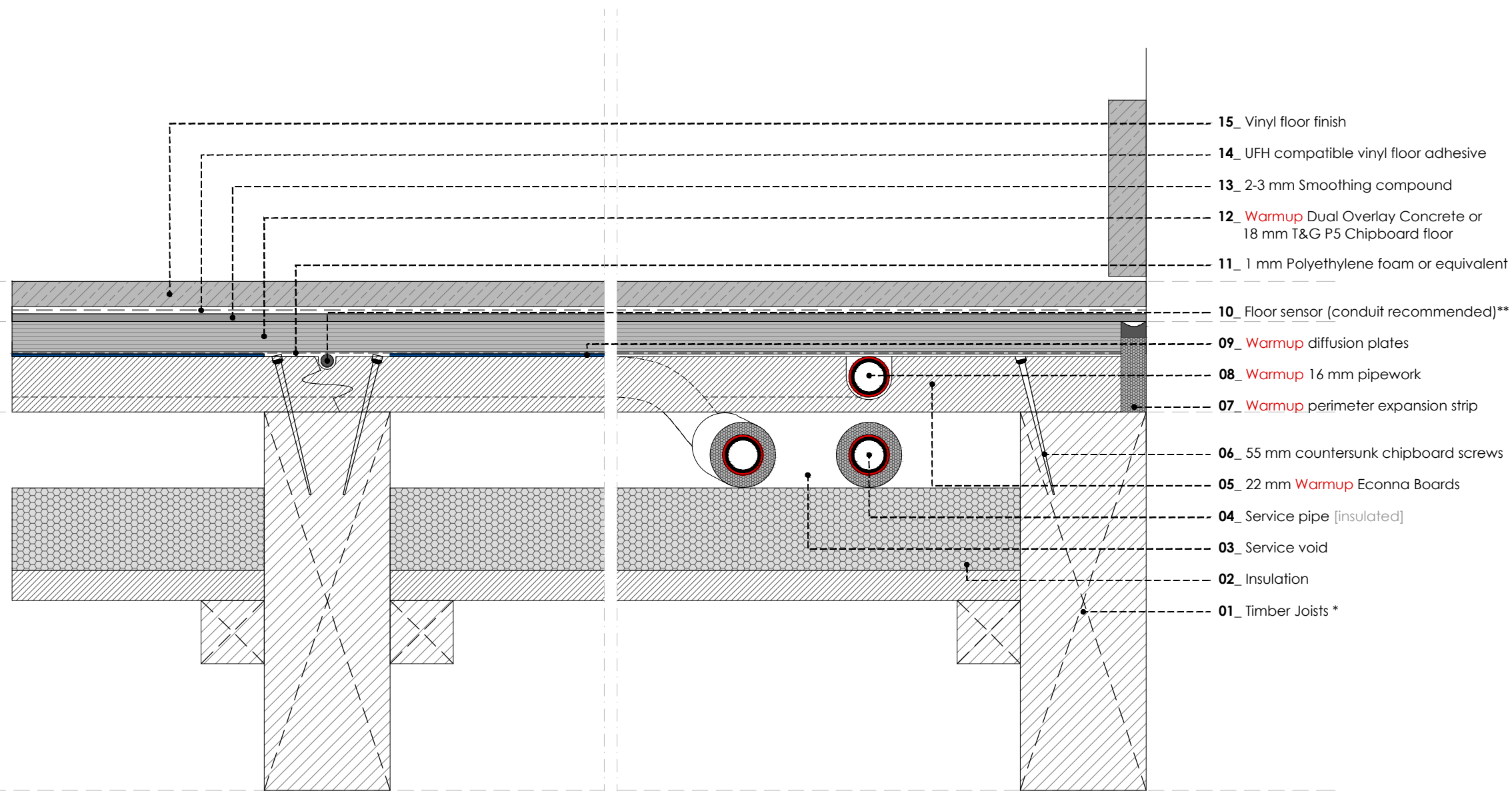

REV	DATE	DESCRIPTION	DR	CH



Warmup

The world's **best-selling** floor heating brand™

WARMUP PLC, 704 Tudor Estate, Abbey Road, London, NW10 7UW
 Tel 0845 034 8270 Fax 0208 453 6869
cad@warmup.com projects@warmup.com www.warmup.co.uk

DRAWING ISSUE STATUS		DRAWING NO
CONSTRUCTION		07
PROJECT		
ECONNA JOISTED FLOOR SYSTEM		
TIMBER SUBFLOOR		
TITLE		
VINYL FLOOR - GLUED		
DETAILED SECTION		
PROJECT MANAGER	DRAWN	CHECKED
	AA	AW
DATE	SCALE	REVISION
28.02.2017	1:50@A3	
CAD FILE		
20170228-H-ECONNA-DET SECTIONS.DWG		

WARMUP ECONNA JOISTED FLOOR SYSTEM. Timber subfloor. Vinyl floor - glued

* Maximum joist spacing c/c is 600mm.
 ** The aluminium plates should be trimmed to allow 50mm spacing between the sensor and the diffuser plates.

© This drawing is confidential and may not be used, copied or disclosed to anyone without permission of Warmup Plc. The Copyright of these drawings remain the property of Warmup Plc.

Do not scale from drawings, all dimensions to be checked on site.

The Warmup word and associated logos are trade marks. © Warmup Plc. 2010 - Regd. TM Nos. 1257757, 4409926, 5265707. E & OE. Registered in England No. 2955213.

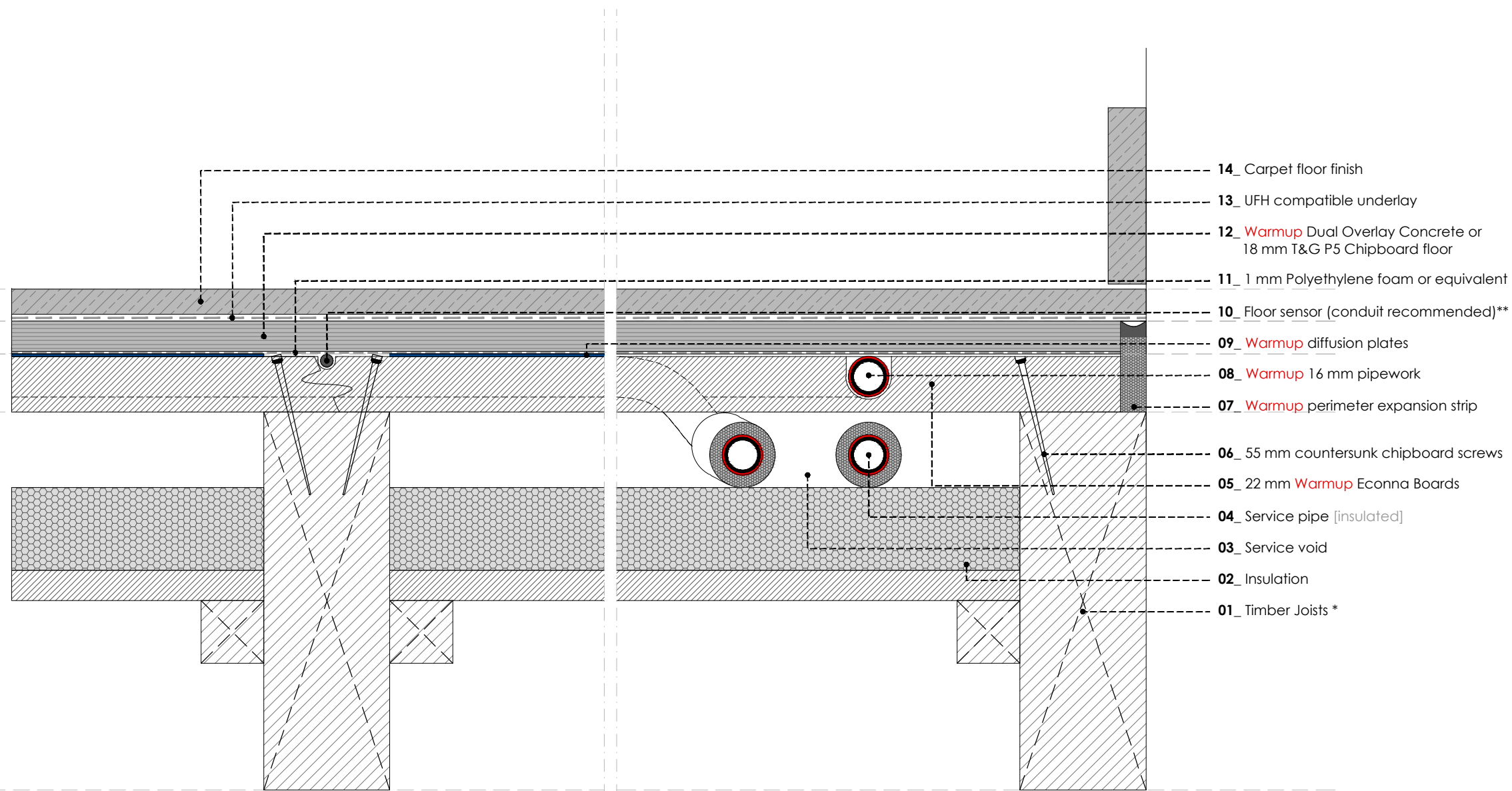

- 14_ Carpet floor finish
- 13_ UFH compatible underlay
- 12_ Warmup Dual Overlay Concrete or 18 mm T&G P5 Chipboard floor
- 11_ 1 mm Polyethylene foam or equivalent
- 10_ Floor sensor (conduit recommended)**
- 09_ Warmup diffusion plates
- 08_ Warmup 16 mm pipework
- 07_ Warmup perimeter expansion strip
- 06_ 55 mm countersunk chipboard screws
- 05_ 22 mm Warmup Econna Boards
- 04_ Service pipe [insulated]
- 03_ Service void
- 02_ Insulation
- 01_ Timber Joists *

WARMUP ECONNA JOISTED FLOOR SYSTEM. Timber subfloor. Carpet floor

* Maximum joist spacing c/c is 600mm.
 ** The aluminium plates should be trimmed to allow 50mm spacing between the sensor and the diffuser plates.

REV	DATE	DESCRIPTION	DR	CH



The world's **best-selling** floor heating brand™

WARMUP PLC, 704 Tudor Estate, Abbey Road, London, NW10 7UW
 Tel 0845 034 8270 Fax 0208 453 6869
cad@warmup.com projects@warmup.com www.warmup.co.uk

DRAWING ISSUE STATUS		DRAWING NO
CONSTRUCTION		08
PROJECT		
ECONNA JOISTED FLOOR SYSTEM		
TIMBER SUBFLOOR		
TITLE		
CARPET FLOOR		
DETAILED SECTION		
PROJECT MANAGER	DRAWN	CHECKED
	AA	AW
DATE	SCALE	REVISION
28.02.2017	1:50@A3	
CAD FILE		
20170228-H-ECONNA-DET SECTIONS.DWG		

© This drawing is confidential and may not be used, copied or disclosed to anyone without permission of Warmup Plc. The Copyright of these drawings remain the property of Warmup Plc.

Do not scale from drawings, all dimensions to be checked on site.

The Warmup word and associated logos are trade marks. © Warmup Plc. 2010 - Regd. TM Nos. 1257757, 4409926, 5265707. E & OE. Registered in England No. 2955213.