

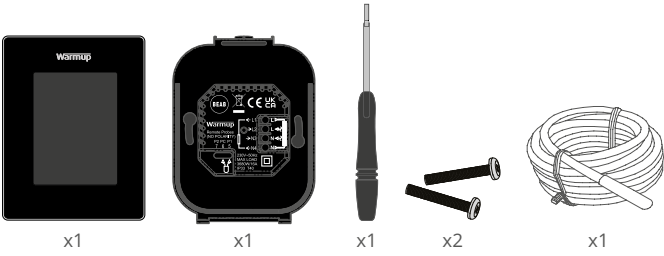

7iE

 matter

Pack Contents



Contents

- [Safety Information..... 3](#)
- [Step 1 - Installation..... 3](#)
- [Step 2 - Wiring Connections 4](#)
 - [Wiring Connections - Loads over 16 amps..... 5](#)
- [Step 3 - Thermostat Mounting 6](#)
- [Step 4 - Initial Setup..... 6](#)
- [Step 5 - Add Location and Room..... 6](#)
- [Welcome to the 7iE..... 7](#)
- [Getting Started 7](#)
 - [How to quickly change the temperature 7](#)
 - [How to quickly change mode 7](#)
- [Heating..... 8](#)
 - [How to set a program..... 8](#)
 - [Setback Temperature..... 8](#)
 - [How to set into Manual Mode..... 9](#)
 - [How to set into Holiday Mode..... 10](#)
 - [How to switch “Heating Off” 10](#)
- [How to Connect to Matter enabled App..... 11](#)
- [Energy Monitor..... 12](#)
- [SmartGeo..... 12](#)
- [Settings..... 13](#)
- [Advanced Settings 14](#)
- [Troubleshooting..... 15](#)
- [WiFi Troubleshooting 16](#)
- [Technical Specifications 17](#)
- [UK PSTI Statement of Compliance..... 18](#)
- [EcoDesign compliance information card..... 19](#)
- [Warranty 20](#)
- [Appendix 1.0 - Thermostat use cases 21](#)

Safety Information

- ❑ The 7iE must be installed by a qualified electrician. It requires a permanent 230 V AC supply from a 30mA RCD or RCBO protected circuit in accordance with the current edition of the BS7671 Wiring Regulations.
- ❑ Isolate the 7iE from the mains supply throughout the installation process. Ensure that wires are fully inserted into the terminals and secured, free strands should be trimmed, as they could cause a short-circuit.
- ❑ Install the 7iE in an area with good ventilation. It should not be beside a window/door, in direct sunlight or above another heat generating device (e.g. radiator or TV).
- ❑ Ensure the distance from your router to the 7iE is not excessive. This will ensure the wireless connection is not subject to range issues once installed.
- ❑ For bathroom installations the 7iE **MUST** be mounted outside of Zones 0, 1 and 2. If this is not possible then must be installed in an adjacent room, controlling the rooms using remote sensor(s).
- ❑ The 7iE and its packaging are not toys; do not allow children to play with them. Small components and packaging present a risk of choking or suffocation.
- ❑ The 7iE is suitable for indoor use only. It must not be exposed to moisture, vibrations, mechanical loads or temperatures outside of its rated values.
- ❑ For safety and licensing reasons (CE/UKCA), unauthorised change and/or modification of the 7iE is not permitted.

Step 1 - Installation

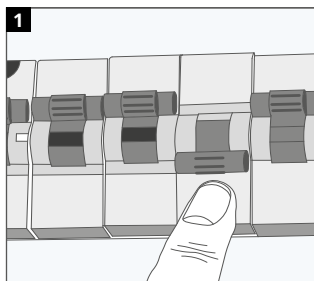

Isolate the 7iE supply from the mains supply.

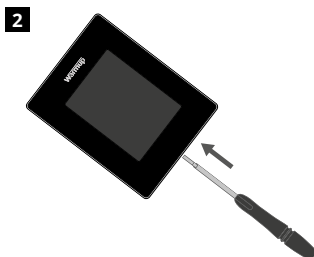

Unclip the display from the power base.

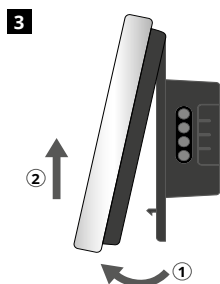

Release the display as shown.

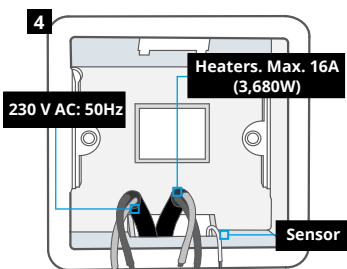

Install a 50 mm deep electrical back box in your preferred thermostat location. Pull wires (heater, supply and sensor(s)) through back box and complete terminal wiring.

Step 2 - Wiring Connections

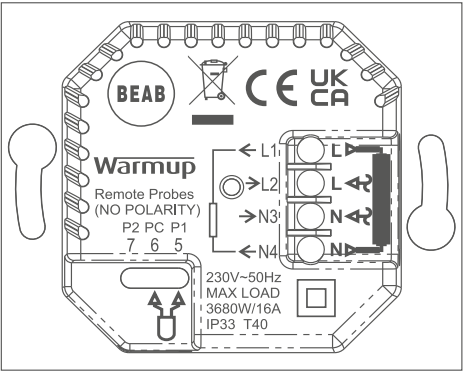

WARNING!

The 7iE must be installed by a qualified electrician in accordance with the current edition of the BS7671 Wiring Regulations. Wire the 7iE using the diagram above and heater type wiring information below.

NOTE: For loads above 10 A, the conductor wire gauge should be at least 2.5mm²

ELECTRIC UNDERFLOOR HEATING

- L1 & N4** Heater Live and Neutral Max. 16A (3680W)
- L2 & N3** Supply Live and Neutral
- 5 & 6*** Floor Sensor (No Polarity)

HYDRONIC UNDERFLOOR HEATING

- L1** Switched Live to Wiring Centre
- L2 & N3** Supply Live and Neutral
- N4** Not Used
- 5 & 6*** Floor Sensor (No Polarity)

• Floor sensor connection;

- 5 & 6** Scheduled floor temperature with air limit
- 6 & 7** Scheduled air temperature with floor limit

Refer to Appendix 1.0 for alternative thermostat use cases

NOTE: The function of Probe 1, Probe 2 from Control/Limit Sensor can be swapped in Advanced Settings; Sensors & Application.

CENTRAL HEATING

- L1** Switched Live to Zone Valve/Boiler
- L2 & N3** Supply Live and Neutral
- N4** Not Used
- 5 & 6** Not Used

For extra low voltage or volt-free systems a contactor must be used. Connecting the 7iE directly to extra low voltage or volt-free boilers may cause damage to the boiler circuit.

Step 2 - Wiring Connections - Loads over 16 amps

Warmup thermostats are rated for a maximum of 16 amps (3680 W). A contactor must be used to switch loads exceeding 16 amps. Please see wiring diagram below.

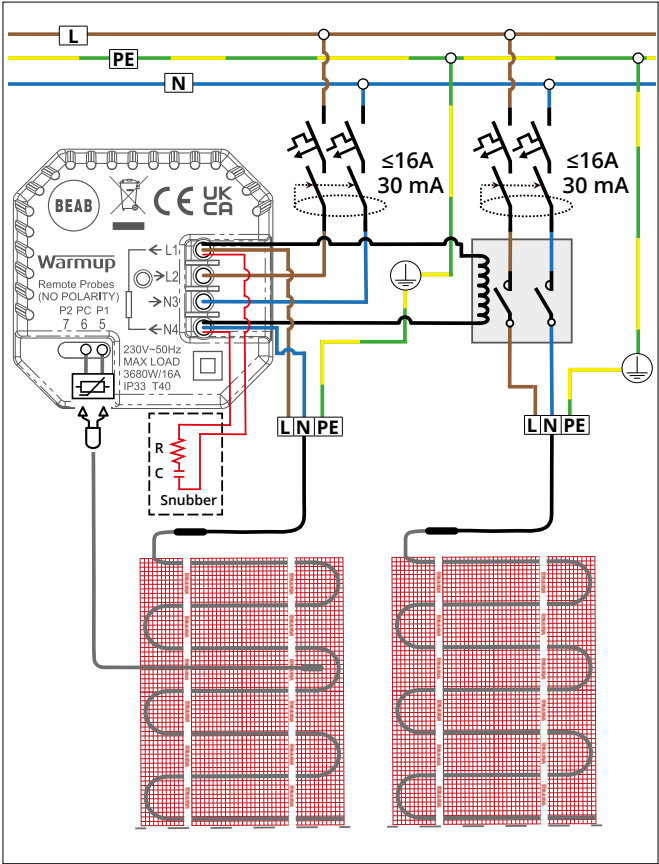

Step 3 - Thermostat Mounting



Insert fixing screws through mounting holes of the power base and tighten.



Re-attach the display until a “click” is heard. You can now restore power to the circuit and power up the thermostat. Follow the on screen instructions to set up your system. Once set up a QR Code will appear.

NOTE: If an external relay or contactor relay has been installed please set System Type as **Electric Relay**.

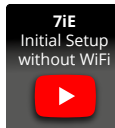

Step 4 - Initial Setup



Download the MyHeating App. The MyHeating App will guide you through the setup of your 7iE. You will have to set up your house location and then the room your new 7iE is located.



A location needs to be setup before a room can be configured and the 7iE device registered. Have details of your current energy tariff and pricing to hand, as these will be required if you wish to use the energy monitoring features.



With a location now setup, the next step is to register a room in which your 7iE is located. This is the heating zone your thermostat will control. Select the 7iE with QR code as shown.



Scan the QR Code on the 7iE screen. Follow the instructions in the App to complete setup.

NOTE: Before scanning the QR code ensure the device you are using for the WiFi connection is set to the 2.4GHz band, as the 7iE only supports connections at 2.4GHz

NOTE: To display the Network Setup QR code on the 7iE if it has returned to the home screen, navigate to: Menu > Settings > Network > Network setup

Welcome to the 7iE



The screenshot shows the main interface of the 7iE thermostat app. At the top, it says 'Warmup' and shows the date 'Thu 11 Mar' and time '17:00'. The central display shows a large '21.0' with 'Floor' underneath it. Below this, it says '23.0° until 11:30'. At the bottom left, it says '18.0° limit'. At the bottom right, it shows a weather icon and '22.0°'. A menu icon (three horizontal lines) is in the bottom center. Callouts point to various elements: 'Heating Indicator' (top right), 'Error Messages' (top right), 'Current Floor/Air temperature' (center), 'Temporary Override' (right side slider), 'Target Temperature' (center), 'Weather' (bottom right), 'Menu' (bottom center), and 'Air limit' (bottom left).

Heating Indicator
Displays when heating is active

Error Messages
See Troubleshooting Page

Current Floor/Air temperature
Floor will be displayed if floor sensor is installed and switched on

Temporary Override
Use the slider or press the +/- icons to set a temporary override until next heating period

Target Temperature
Temperature you wish the thermostat to achieve

Weather
7-day forecast for your area

Menu

Air limit
Will only be displayed when in floor mode and an air limit is set.
See Appendix 1.0 for alternative thermostat use cases

Getting Started



How to quickly change the temperature

Use the slider or press the +/- icons to change your target temperature.

If in **"Program"** mode this will set a temporary override until your next heating period.

If in **"Manual"** mode this will set a fixed target temperature.

Once the target temperature is set above current floor/air temperature the heating indicator will appear.



How to quickly change mode

Mode select allows you to quickly change from program, manual or holiday modes. You can also switch **"Frost Protection"** on or simply switch the **"Heating Off"** from here. Frost protection will ensure that the floor/air temperature does not drop below 7.0°.

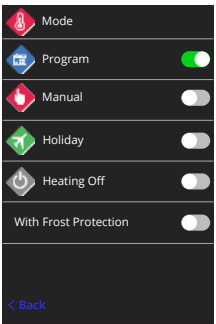
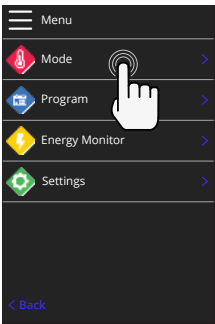
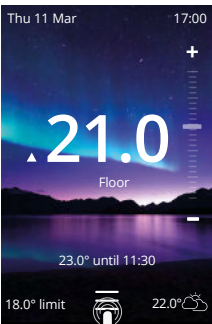

How to set a program

Setting a “Program” allows you to set comfort temperatures at set times throughout the day. Days can be programmed individually, all days the same or weekdays as a block and weekends as a block, the choice is yours.

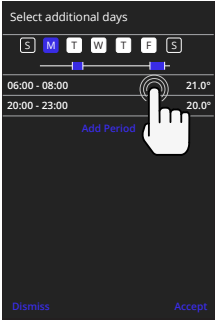
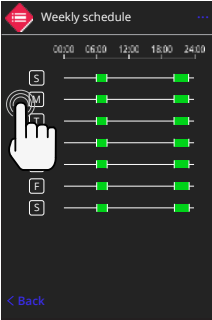
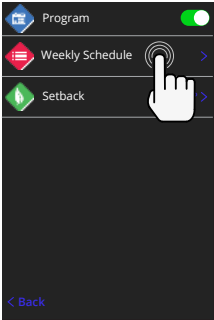
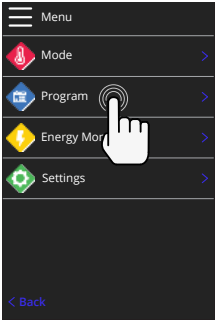
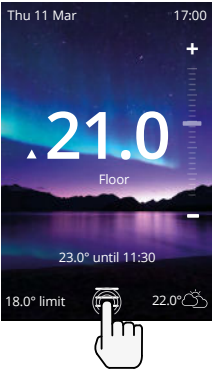

To “Select additional days” press the days of the week and the squares will be highlighted in white as shown and will follow the programmed heating schedule. Once you are happy press “Accept” to save the heating schedule.

NOTE: For tailor-made preset heating schedules for different room types press the three dots “...” on the weekly schedule page.

Setback / Sleep Temperature

The “Setback” temperature is a lower energy efficient temperature when outside of a heating period.

The sleep temperature applies between the last scheduled comfort period and the start of the next day's first scheduled comfort period.

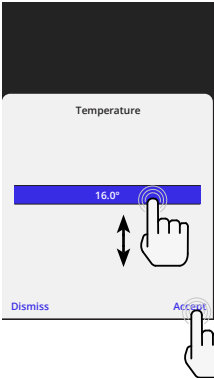
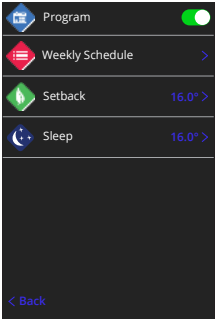

How to set into Manual Mode

Setting into “Manual” mode allows you to set a fixed target temperature for the thermostat to achieve. The thermostat will continue to maintain this temperature until another operating mode or temperature is selected. Alternatively go to “Program” from the Menu screen and switch Program off.

7iE

How to set into Manual Mode

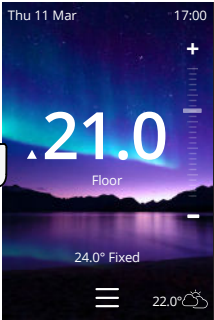
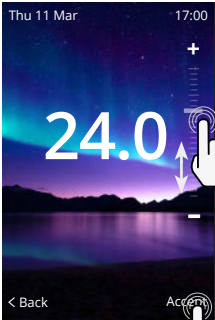
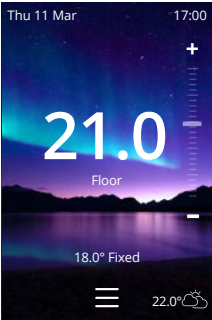
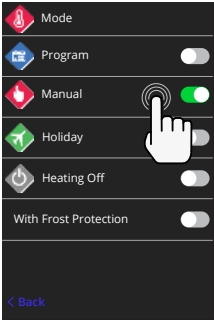
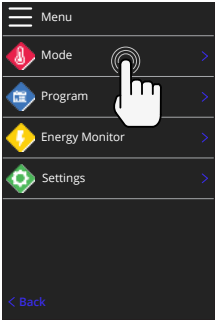
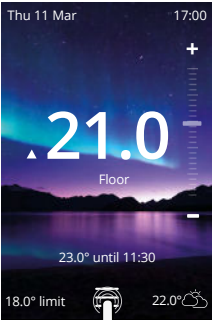

Heating

How to set into Holiday Mode

“Holiday Mode” allows you to override your schedule with a lower fixed temperature over a set time to save energy.

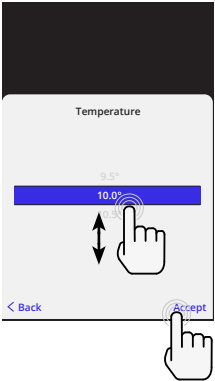
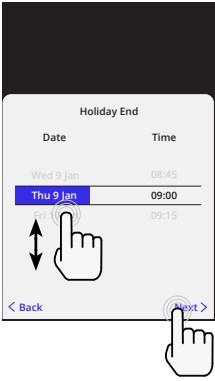
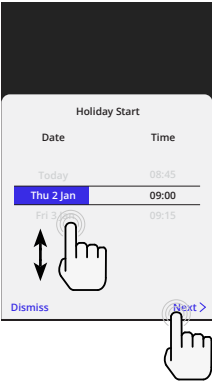
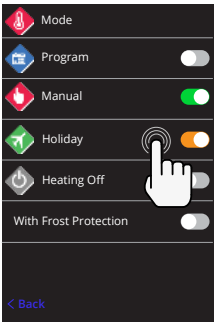
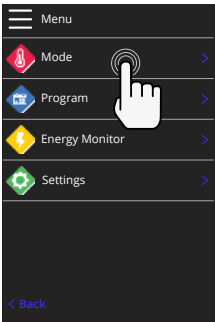
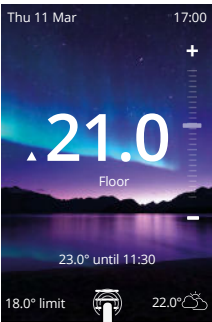

How to switch “Heating Off”

This will switch the heating off until you cancel it by pressing “Heating Off” on the homescreen or going into mode select and pressing the “Heating Off” slider.

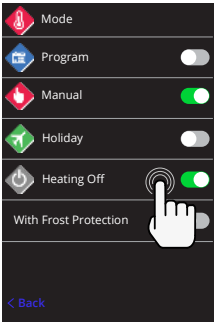
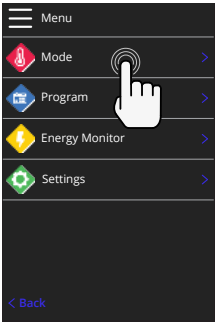

How to Connect to Matter enabled App



matter

If you want to connect your 7iE to a Matter enabled app, go to 'network setup', select 'connect to Matter app' and use your Matter enabled app to scan the QR code displayed on the 7iE screen

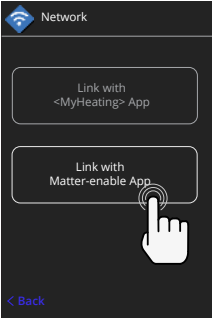
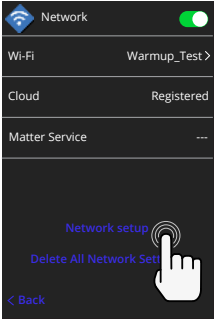
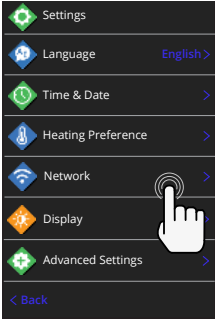
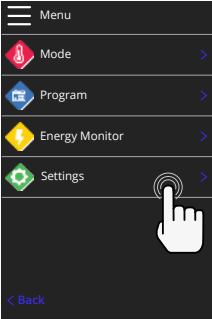

Energy Monitor

Energy Usage	
Last 24 Hours	1.5kWh
Last 7 Days	0.0kWh
Last 30 Days	0.0kWh
Since reset	0.0kWh
Reset record	
< Back	

How Energy Monitor works

The 7iE learns how you use your system and how your house reacts to heating and weather. Energy monitoring will show the amount of energy consumed over a certain time period. This will be calculated through system power multiplied by efficiency and run time.

You will need to enter the power of your system, and in some cases, the efficiency.

If you do not know these, speak to your installer or system manufacturer.

Power Settings

1,500 W

1

2

3

4

5

6

7

8

9

0

✕

Dismiss

Accept

Changing the Power Settings

If you have entered the wrong system power during setup it can be changed in Energy Monitor; Power Settings.

SmartGeo

How SmartGeo works





SmartGeo is a unique technology developed by Warmup and built into the MyHeating App that uses an advanced algorithm to understand the most efficient heat settings for your home.

Working automatically; it learns your routines and location through background communication with your smartphone and lowers temperatures when you are away, only rising them up to your ideal comfort temperature in time for your arrival home.

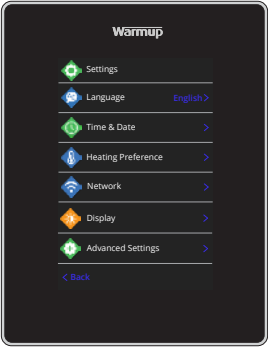
Smartgeo will operate when the thermostat is in the program or manual run modes. It is turned off by default. Use the MyHeating App to switch SmartGeo on.





Language Settings	Change the 7iE language	
Time & Date	Change the Time and Date	
	Daylight savings	On/Off
	24-hour time	On/Off
Heating Preference	Temperature unit	°C/°F
	Open window detection 	On/Off
	<i>The windows open detection feature is designed to switch off heating to save energy when the thermostat detects that a window or door has been opened and, the outside air temperature is significantly below the indoor temperature.</i>	
	Adaptive Learning	On/Off
	<i>Adaptive learning will use the historic heating/cooling rates for the time of day, historic external temperatures and the forecast external temperatures, to work out the heating start time in order to reach the comfort time at the start of the comfort period. It will only work in Program Mode.</i>	
Network	WiFi Connection	On/Off
	<i>It is possible to set a new WiFi connection from here. The current network connection can also be viewed from this menu, including the signal strength.</i>	
Display	Background 	Light Dark Random
	<i>Choose the background image of the 7iE. Random is an image selected from Warmup's collection.</i>	
	Standby style 	Temperature Time Minimalist
	<i>Choose what will be displayed when the 7iE goes into standby. Temperature will display current temperature; Time will display the current time; Minimalist will show neither.</i>	
	Brightness 	Active Standby Night
	<i>Adjust the brightness of the 7iE screen when in Active, Standby or Night Mode.</i>	

Settings

Display, cont'd	Night period	Set the Start and End period
	<i>This is the time when you usually go to bed at night and wake up in the morning. The brightness of "Night" mode will begin and end using this time.</i>	
	Screen lock 	On/Off
	<i>Locks the 7iE screen to prevent any unauthorised changes to the 7iE. Requires a 4 digit code to access the menu or make changes.</i>	

Advanced Settings

Advanced settings	Sensors & Application	Internal Air Sensor	Offset +/- 10°
		Probe 1 Connected	On/Off
			Type 5, 10, 12, 15, 33, 100K Offset +/- 10°
		<i>The 7iE uses a 10K sensor. However, if using a 7iE to replace an existing thermostat you must change to the correct sensor type.</i>	
		Probe 2 Connected	On/Off
			Type 5, 10, 12, 15, 33, 100K Offset +/- 10°
		<i>If a 2nd sensor is wired into terminals 6 & 7 it must be switched on here to act as a limit sensor.</i>	
		Floor thermostat (Probe 1 On, Probe 2 Off. See Appendix 1.0 for alternative thermostat use cases)	Control Floor Remote Air Regulator Limit None/Air
		<i>Choose to switch the method of control for the sensor; floor sensor, remote air sensor if not installed underneath the floor or regulator mode.</i>	
		<i>Regulator Mode; Heating is on for X% out of control cycle (default 10mins). Heating is off for remaining time.</i>	
		Swap Probe Usage	On/Off
		Floor type*	Tile/Stone Laminate Carpet Wood Vinyl Other
		<i>Choose the floor type of your installation. This will apply different temperature and overheat limits to the 7iE.</i>	

* Not applicable if conventional heating system was selected.

Advanced Settings

Advanced settings	Temperature limits	Set Min./Max. settable temperature limits
	Overheat limit	Set Overheat air limit if floor sensor has been installed
	Control Period	Set between 10 - 60 mins.
	<i>Control period checks the difference in the current measured temperature and the set temperature in a proportional integral algorithm to maintain a steady temperature.</i>	
	About	Details about the 7iE's current firmware, MAC address and WiFi connection information.

Troubleshooting

Display is blank	Brightness	1. Check that the standby brightness is not set to Off.
	Power	2. (Electrician Required) Electrician required to verify power is going to the 7iE and that it is correctly wired.
ER1	Sensor Error	<p>(Electrician Required) Electrician required to verify that the floor sensor has been wired correctly. If it is correctly wired the electrician will need to check the resistance of the floor sensor using a multi meter. For temperatures between 20°C - 30°C the resistance of the floor sensor should measure between 8K ohms and 12K ohms.</p> <p>If the electrician finds a fault, and the 7iE is in the room to be heated then it can be set into "Air Mode".</p> <p>To set into "Air Mode", go to Sensors & Application in Advanced Settings and switch the probe off.</p>
Heating is coming on earlier than programmed times	Adaptive learning On	Adaptive learning will use the historic heating/cooling rates for the time of day, historic external temperatures and the forecast external temperatures, to work out the heating start time in order to reach the comfort time at the start of the comfort period. It will only work in Program Mode.
Cannot to set above a certain temperature	Floor Type Temperature Limits	Delicate floor coverings need to have their temperatures limited. If the finished floor is set for wood, laminate, vinyl etc. you are unable to set the temperature above 27°C.
WiFi Error Symbol	WiFi not setup	If you have not done so, download the MyHeating App, go to Settings and Network setup and follow the on screen instructions to connect to a WiFi Network.
	WiFi disconnected	<p>Follow the step above to try and to re-connect to the WiFi Network.</p> <p>If the 7iE still fails to connect, see WiFi Troubleshooting.</p>
Clock Sync Icon	Time and Date not set	Connect the 7iE to a WiFi network or alternatively set the time and date from the settings menu.

WiFi Troubleshooting

Before following the troubleshooting guide below please check the following:

- 1. The password is WPA2 protected.
- 2. The router is set to a 2.4 GHz band. (802.11 b, g, n, b/g mixed, b/g/n mixed)

NOTE: If you need to change any of the items listed above, please refer to your router manual.

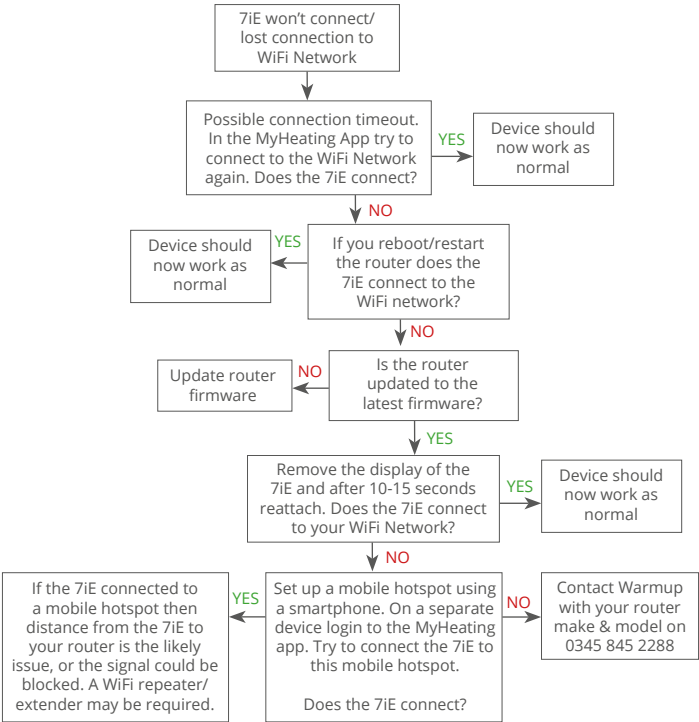

Technical Specifications

Model	7iE-01-XX-YY
Operating Voltage	230 V AC : 50 Hz
Protection Class	Class II 
Max. Load	16A (3680W)
Rated impulse voltage	4000V
Automatic action	100,000 cycles
Disconnection means	Type 1B
Pollution degree	2
Max. Ambient Temperature	0 - 40°C
Relative Humidity	80%
IP Rating	IP33
Dimensions (Assembled 7iE)	90 x 115 x 39 mm
Screen size	3.5in
Sensors	Air & Floor (Ambient)
Sensor Type	NTC10k 3m Long (Can Be Extended To 50m)
Operating Frequency	2401 - 2484MHz
Max. Radio-Frequency Power Transmitted	20dBm
Installation Depth	Recommended: 50 mm Back Box
	Minimum: 35mm Back Box
Compatibility	Electric, Hydronic Underfloor Heating. Max. 16A (3680W) Central Heating Systems (Combi & system boilers with switch live, 230V AC input)
Er-P Class	IV
Warranty	12 Years
Approvals	BEAB

Hereby, Warmup plc, declares that the radio equipment type 7iE-01-XX-YY is in compliance with the RED Directive 2014/53/EU and Radio Equipment Regulations 2017. The declarations of conformity may be consulted by pressing the CE or UKCA icon.



Instructions for Disposal

Do not dispose of the device with regular domestic waste! Electronic equipment must be disposed of at local collection points for waste electronic equipment in compliance with the Waste Electrical and Electronic Equipment Directive.



UK PSTI Statement of Compliance

We, Warmup plc, as manufacturer, hereby declare in our opinion, that the below product(s) covered in this document have complied the deemed compliance conditions in Schedule 2 of The Product Security and Telecommunications Infrastructure (Security Requirements for Relevant Connectable Products) Regulations 2023 ("Security Requirements"). Deemed compliance was made using specific clauses of ETSI EN 303 645 V2.1.1 (2020-06) as required by the PSTI "Security requirements".

Product	Warmup 7iE
Model	7iE-01-BP-LC, 7iE-01-CW-LC, 7iE-01-OB-DC
Defined Support Period (UK only)	2 Years
Manufacturer's Name	Warmup plc
Manufacturer's Address	704 Tudor Estate, Abbey Road, London, NW10 7UW, UK

This statement of compliance is prepared by or on behalf of the manufacturer of the product.

Signature	
Name	Antony White
Title	Technical Director
Place	London, UK
Date	19/04/2024

Please note that this statement of compliance, including the Defined Support Period stated herein, is only applicable to products sold in the UK.

EcoDesign compliance information card

This control has the following control functions and exceeds the EcoDesign requirements for electric underfloor local space heaters and towel rails as set out in Commission Regulation (EU) 2024/1103: **TW (f2/f3/f4/f8)**

The Warmup 7iE includes these control function codes and power consumptions:

Thermostat model					
7iE (7iE-01)					
Control function code					
TW (f2/f3/f4/f8)					
Power consumption					
Off mode	Standby mode			Idle mode	
$P_o \leq 0.5W$	$P_{sm} \leq 0.5W$	$P_{dsm} \leq 1.0W$	$P_{nsm} \leq 2.0W$	$P_{idle} \leq 1.0W$	$P_{nidle} \leq 3.0W$
<input checked="" type="checkbox"/>			<input checked="" type="checkbox"/>		<input checked="" type="checkbox"/>

Type of heat output/room temperature control		
TD	Electronic room temperature control plus day timer	<input type="checkbox"/>
TW	Electronic room temperature control plus week timer	<input checked="" type="checkbox"/>
Other control options		
f2	Open window detection	<input checked="" type="checkbox"/>
f3	Distance control option	<input checked="" type="checkbox"/>
f4	Adaptive start control	<input checked="" type="checkbox"/>
f7	Self-learning functionality	<input type="checkbox"/>
f8	Control accuracy	<input checked="" type="checkbox"/>

Room temperature control power consumption		
The control must include an off mode and/or a standby mode, in addition to an idle mode. The power consumption must comply with requirements for each mode where applicable.		
In off mode	$P_o \leq 0.5W$	<input checked="" type="checkbox"/>
In standby mode	$P_{sm} \leq 0.5W$	<input type="checkbox"/>
	$P_{dsm} \leq 1.0W$ (if control has an active display in standby mode)	<input type="checkbox"/>
	$P_{nsm} \leq 2.0W$ (if control has a network connection in standby mode)	<input checked="" type="checkbox"/>
In idle mode	$P_{idle} \leq 1.0W$	<input type="checkbox"/>
	$P_{nidle} \leq 3.0W$ (if control has a network connection)	<input checked="" type="checkbox"/>

Control function codes (Required to be in manual as part Regulation (EU) 2024/1103)

		Code of temperature control (TC)	Control functions							
			f1	f2	f3	f4	f5	f6	f7	f8
Type of temperature control	Single stage, no temperature control	NC								
	Two or more manual stages, no temperature control	TX								
	Mechanic thermostat room temperature control	TM								
	Electronic room temperature control	TE								
	Electronic room temperature control plus day timer	TD								
	Electronic room temperature control plus week timer	TW								
Control functions	Presence detection		1							
	Open window detection			2						
	Distance control option				3					
	Adaptive start control					4				
	Working time limitation						5			
	Black bulb sensor							6		
	Self-learning functionality								7	
	Control accuracy with CA < 2 Kelvin and CSD < 2 Kelvin									8

Warmup plc T: 0345 345 2288 F: 0345 345 2299 www.warmup.co.uk
704 Tudor Estate ■ Abbey Road ■ London ■ NW10 7UW ■ UK
Warmup GmbH ■ Ottostraße 3 ■ 27793 Wildeshausen ■ DE

Warranty

Warmup plc warrants this product, to be free from defects in the workmanship or materials, under normal use and service, for a period of twelve (12) years from the date of purchase by the consumer when installed with a Warmup heater.



If at any time during the warranty period the product is determined to be defective, Warmup shall repair or replace it, at Warmup's option. If the product is defective, please either;

Return it, with a bill of sale or other dated proof of purchase, to the place from which you purchased it, or

Contact Warmup. Warmup will determine whether the product should be returned or replaced.





















The twelve (12) year warranty only applies if the product is registered with Warmup within 30 days after purchase. Registration can be completed online at www.warmup.co.uk

This warranty does not cover removal or re-installation costs and shall not apply if it is shown by Warmup that the defect or malfunction was caused by failure to follow the instruction manuals, incorrect installation or damage which occurred while the product was in the possession of a consumer. Warmup's sole responsibility shall be to repair or replace the product within the terms stated above. If the 7iE is installed with a non-Warmup heater a three (3) year warranty will apply. This warranty does not extend to any associated software such as apps or portals.

WARMUP SHALL NOT BE LIABLE FOR ANY LOSS OR DAMAGE OF ANY KIND, INCLUDING ANY INCIDENTAL OR CONSEQUENTIAL DAMAGES RESULTING, DIRECTLY OR INDIRECTLY, FROM ANY BREACH OF ANY WARRANTY, EXPRESS OR IMPLIED, OR ANY OTHER FAILURE OF THIS PRODUCT. THIS WARRANTY IS THE ONLY EXPRESS WARRANTY WARMUP MAKES ON THIS PRODUCT. THE DURATION OF ANY IMPLIED WARRANTIES, INCLUDING THE WARRANTIES OF MERCHANTABILITY AND FITNESS FOR A PARTICULAR PURPOSE, IS HEREBY LIMITED TO THE TWELVE-YEAR DURATION OF THIS WARRANTY.

This Warranty does not affect your statutory rights.

Appendix 1.0 – Thermostat use cases

No.	Reg. Mode	Probe P1 (5 & 6)	Probe P2 (6 & 7)	Control	Limit Sensor	Use Case
1	OFF	OFF	OFF	Internal Air Sensor	None	  Thermostat in room air temperature schedule no floor limit
2		ON	OFF	P1 Floor Sensor	None	 Thermostat in/out of room floor temperature schedule floor limit
3					Internal Air Sensor	  Thermostat in room floor temperature schedule air limit
4				P1 Air Sensor	None	  Thermostat out of room air temperature schedule no floor limit
5		OFF	ON	Internal Air Sensor	P2 Floor Limit	  Thermostat in room air temperature schedule floor limit
6		ON	ON	P1 Floor Sensor	P2 Floor Limit	 Thermostat in/out of room floor temperature schedule floor limit
7				P1 Air Sensor	P2 Floor Limit	  Thermostat out of room air temperature schedule floor limit
8	ON	OFF	OFF	Reg.	None	   Thermostat in/out of room regulator schedule no limit
9					Internal Air Sensor	   Thermostat in room regulator schedule air limit
10		OFF	ON	Reg.	P2 Floor Limit	  Thermostat in/out of room regulator schedule floor limit

 Conventional
  Electric underfloor heating
  Hydronic underfloor heating

Warmup



Warmup plc

www.warmup.co.uk

uk@warmup.com

T: 0345 345 2288

F: 0345 345 2299

Warmup plc ■ 704 Tudor Estate ■ Abbey Road ■ London ■ NW10 7UW ■ UK
Warmup GmbH ■ Ottostraße 3 ■ 27793 Wildeshausen ■ DE